

Public Right of Way User Evidence Form

About the application route

1. Is the application route:

- A footpath (public rights on foot only)
- A bridleway (public rights on foot and on horseback or bicycle)
- A restricted byway (public rights on foot, on horseback or any non-motorised vehicle)
- A byway open to all traffic (public rights for all classes of use, including motor vehicles)

2. Describe the application route (include start and finish points and provide OS grid references if you can)

FROM POINTS A to B ON THE
ENCLOSED MAP

Map of the application route

Please attach an extract from a map of your choice (1:2500 scale if possible) and identify the exact route you are providing evidence about (draw the route on the map so it is obvious). Please annotate the map with anything you provide details about in this form, for example, the location of a gate or sign. Please put your initials on your map and date it. **Please do not add your full signature.**

3. Why do you regard this way as public?

I HAVE ALWAYS KNOWN IT AS A PUBLIC
FOOTPATH

Your use of the application route

4. In which years did you use the application route?

From 1991 To 2023

5. Were there any extended periods during which you did not use the route at all? If so, please state when and why?

..... N.O.

6. How did you use the application route and how often? [Please tick any that apply]

	Daily	Weekly	Monthly	Every few months	Once a year	Other (please describe)
On foot		✓				
On horseback						
By pedal cycle						
By motor vehicle						
By horse-drawn vehicle						

7. Where were you going, and for what purpose?

..... RECREATIONAL WALKING

8. Has the application route always followed the same course?

Yes

No

If no – how and when was the route altered?

.....

9. Approximately how wide is the application route?

[Please give your estimate of the width across which you used the route including the width used when passing others or walking with others. Take care to consider the overall width of the route. If this varies, please describe how. Or please state 'don't know']

..... DON'T KNOW EXACT MEASUREMENTS

..... NO

10. What type of surface does the application route have? (for example grass, gravel, earth)
[Are there any changes along its length]

..... GRAVEL AND EARTH

11. Have there ever been any of the following on the application route?

Stiles [state locations and show on your map]

..... NO

How long were they in place?

Gates [state locations, indicate whether locked – and when – and show on your map]

..... NO

Other barriers [state what they were and location, how long they were in place and show on your map]

..... NO

12. Did any of the above prevent you from using the application route?

No

Yes

If yes, please give details

.....

13. Have you ever seen any signs or notices suggesting whether or not the application route is a public right of way? (for example "Private", "Keep Out", "No Right of Way" "Trespassers will be Prosecuted")

No

Yes

If yes – state when and give details, including when they were present and mark their location on your map

I HAVE SEEN PRIVATE NOTICES
ATTACHED TO PROPERTIES

14. Have you seen other people using the application route whilst you have been using it?

No

Yes

If yes, please provide any additional information about this

I HAVE FREQUENTLY MET PEOPLE USING
THIS PATH INCLUDING TOURISTS AND PILGRIMS
ACCESSING ST. MARY'S WELL AND THE CHAPEL

Land Ownership

15. Were you working for any owner or occupier of land crossed by the application route at the time when you used it, or were you then a tenant / licensee of any such owner?

No

Yes

16. Did the owner or occupier ever give you permission (or did you seek permission) to use the application route?

No

Yes

17. Has anyone ever told you the application route was not public (including by an owner, tenant of the land or by anyone in their employment)?

No

Yes

18. Have you ever been stopped or turned back when using the application route?

No
 Yes

If yes, by whom and when?

.....
.....
.....

19. Has anyone else ever told you that they were prevented from using the application route?

No
 Yes

If yes, please give details including when this happened

.....
.....
.....

20. Have you ever had a private right to use the application route? (for example, an easement, private right of access, licence, etc)

No
 Yes

If yes, please give full details, including who gave the permission, why and when

.....
.....
.....

Other Information

21. Do you have, or do you have knowledge of, any documentary evidence which is relevant to the application route or which indicates public use? (for example photographs, guidebooks, letters, sale documents, old maps, etc)

No
 Yes

If yes – please provide details

.....
.....



Existing public highway (indicative only)

Plan to accompany User Evidence Form
Please draw clearly on the plan the route you have used, preferably in bold black

Please initial and date:

Initials: _____ Date: _____

Scale bar: 0 10 20 40 Meters

For official use only

Ref: 16.

Public Right of Way User Evidence Form

About the application route

1. Is the application route:

A footpath (public rights on foot only)

A bridleway (public rights on foot and on horseback or bicycle)

A restricted byway (public rights on foot, on horseback or any non-motorised vehicle)

A byway open to all traffic (public rights for all classes of use, including motor vehicles)

2. Describe the application route (include start and finish points and provide OS grid references if you can)

From where The Grove meets Eastern end of
Red park Road upto the junction with
Queens Terrace

Map of the application route

Please attach an extract from a map of your choice (1:2500 scale if possible) and identify the exact route you are providing evidence about (draw the route on the map so it is obvious). Please annotate the map with anything you provide details about in this form, for example, the location of a gate or sign. Please put your initials on your map and date it. **Please do not add your full signature.**

3. Why do you regard this way as public?

We have lived at [redacted] Road since
January 1981. During that period school children
have used it to walk/cycle to Heaton Manor. Also
including ourselves people walk down it on a regular basis.

Your use of the application route

4. In which years did you use the application route?

From 1981 To August 15TH 2023 inclusive

5. Were there any extended periods during which you did not use the route at all? If so, please state when and why?

No

6. How did you use the application route and how often? [Please tick any that apply]

	Daily	Weekly	Monthly	Every few months	Once a year	Other (please describe)
On foot		✓				
On horseback						
By pedal cycle						
By motor vehicle						
By horse-drawn vehicle						

7. Where were you going, and for what purpose?

Dog walking.

8. Has the application route always followed the same course?

Yes

No

If no – how and when was the route altered?

9. Approximately how wide is the application route?

[Please give your estimate of the width across which you used the route including the width used when passing others or walking with others. Take care to consider the overall width of the route. If this varies, please describe how. Or please state 'don't know']

at narrowest point about 3 metres and at widest about 15 metres

10. What type of surface does the application route have? (for example grass, gravel, earth)

[Are there any changes along its length]

Mixture of grass, gravel, earth.

11. Have there ever been any of the following on the application route?

Stiles [state locations and show on your map]

no

How long were they in place?

no

Gates [state locations, indicate whether locked – and when – and show on your map]

no

Other barriers [state what they were and location, how long they were in place and show on your map]

no

12. Did any of the above prevent you from using the application route?

No

Yes

If yes, please give details

13. Have you ever seen any signs or notices suggesting whether or not the application route is a public right of way? (for example "Private", "Keep Out", "No Right of Way" "Trespassers will be Prosecuted")

No

Yes

If yes – state when and give details, including when they were present and mark their location on your map

.....
.....
.....

14. Have you seen other people using the application route whilst you have been using it?

No

Yes

If yes, please provide any additional information about this

General public

.....
.....

Land Ownership

15. Were you working for any owner or occupier of land crossed by the application route at the time when you used it, or were you then a tenant / licensee of any such owner?

No

Yes

16. Did the owner or occupier ever give you permission (or did you seek permission) to use the application route?

No

Yes

17. Has anyone ever told you the application route was not public (including by an owner, tenant of the land or by anyone in their employment)?

No

Yes

18. Have you ever been stopped or turned back when using the application route?

No

Yes

If yes, by whom and when?

.....
.....
.....

19. Has anyone else ever told you that they were prevented from using the application route?

No

Yes

If yes, please give details including when this happened

.....
.....
.....

20. Have you ever had a private right to use the application route? (for example, an easement, private right of access, licence, etc)

No

Yes

If yes, please give full details, including who gave the permission, why and when

.....
.....
.....

Other Information

21. Do you have, or do you have knowledge of, any documentary evidence which is relevant to the application route or which indicates public use? (for example photographs, guidebooks, letters, sale documents, old maps, etc)

No

Yes

If yes – please provide details

.....
.....

-
.....
.....
22. Please give any further information which you consider would be helpful in reaching a decision as to whether the application route should be recorded as a public right of way?
[Continue on a separate sheet if necessary]
[If you wish to provide additional sketch map or drawings, please do so and attach to this statement]

.....
.....
.....
.....
.....
.....
.....

We have used it uninterrupted for 42 years, proof of right of way!

23. During the investigation an officer from the Newcastle City Council may want to talk to or informally interview some or all of the users in order to gather additional information. Would you be willing to provide further information about your knowledge of the application route?

Yes

No

24. Would you be willing to attend a hearing, or public inquiry to give evidence if necessary?

Yes

No

Please make sure you have completed your contact details on pages i, and read the Data Protection information and signed the Statement of Truth on page ii.

Please remember to enclose a map showing the precise line of the route used.

This completed form plus any supporting evidence should either be returned to the person making the application, or if requested (if an application has already been submitted) direct to:

**Public Rights of Way
Place Directorate – Transport
Newcastle City Council
10th Floor, Civic Centre
Barras Bridge
Newcastle upon Tyne
NE1 1QH
Email: prow@newcastle.gov.uk**

Thank you for taking the time to complete this form.

Newcastle
City Council

Newcastle City Council
10th Floor, Civic Centre
Barras Bridge
Newcastle upon Tyne
NE1 1QH



Existing public highway (indicative only)

Plan to accompany User Evidence Form

Please draw clearly on the plan the route you have used, preferably in bold black

Scale: 1:1,500 at A4

Scale bar: 0 10 20 40 Meters

For official use only

Please initial and date:

Initials:

Date: 15 August 2023

Ref:

17.

NEWCASTLE upon TYNE NE2 2RE
tel & fax

29 July 2023

Nick Howell
Public Rights of Way Officer
Place Directorate – Transport
Newcastle City Council
10th Floor
Civic Centre
Newcastle upon Tyne
NE1 1QH

Dear Mr Howell

'The Grove' - evidence in support of Definitive Map Modification Order Application

Thank you for your letter of 24 July. In addition to the Public Right of Way User Evidence Form attached please also take the following into account:

1. Ancient maps suggest that 'The Grove' is one of the few really old roads through Jesmond. Later early OS maps (for example my colour on the attached copies of the 1895 and 1913 maps) show it connecting Osborne Road and Jesmond Dene Road with no indication of gates, stiles, bollards or any other obstruction to free passage. That is how I first knew it in 1980 and I can testify it has been unaltered and in public use continuously at least from 1980 to the present day.
So in the absence of any evidence that it was ever closed before 1980 it is reasonable to believe that at very least it has been in continuous use as a public right of way since 1895.
2. In my collection of photos of Jesmond I find these two photos of successive signs put up by the City on the Osborne Road pavement. I estimate dated between 1990 and 2010. No longer standing though the root can still be seen in the pavement.
So the City itself understood The Grove to be a public access to St Mary's Well, St Mary's Chapel and Jesmond Dene. In particular there being no other way to reach St Mary's Well, these signs are clear evidence that the City treated at least the section between Queen's Terrace and Reid Park Rd as a Public Right of Way.
3. At St Mary's Well (a Scheduled Monument designated in 1929) two signs, both of patterns used by Local Authorities for public information, face The Grove which is further evidence that The Grove passing the Well has in the past been regarded by Local Authorities as open to the public.
4. In recent years the City Council resurfaced the section between Osborne Rd and Queen's Terrace and marked and signed it for public pedestrian and bicycle use.
The old maps show the whole length of The Grove (Osborne Rd to Jesmond Dene Rd) was open to the public before Queen's Terrace was created so logically there can be no case to suggest the east section of The Grove is any less a Public Right of Way for pedestrians and bicycles than the west part. I know that cyclists as well as pedestrians use the east section of The Grove.
5. Further evidence for the east section of The Grove being accepted by the City as a Public Right of Way are the modern public lighting on standards identical to street lighting throughout Jesmond and the street drainage gully found close to its bottom end.

6. Some or all of the dwellings 'The House' 'Grosvenor House' and 52 Grosvenor Avenue appear to have detached garden land north of 'The Grove'. At some point railings have been installed to keep the public to a narrowed pathway north of 52 Grosvenor Avenue. Such railings would not have been installed unless the landowner(s) acknowledged the existence of the Right of Way.
7. Several parts of the land north of the east section of The Grove have gates from The Grove. The boundaries on the map you supplied suggest some ownerships are separate from the Reid Park Road house gardens. Together these suggest some houses on Grosvenor Avenue have further gardens detached from their back gardens. Such patterns of detachment are found in many places in the region. We know for certain that at least one Grosvenor Avenue house (owned by a friend) has such a detached garden.
If The Grove were not a Public Right of Way as a whole such detachment would be unnecessary.

I would like to make other observations about the east section of The Grove perhaps not directly your concern but which I hope you can circulate to the right people in the Civic Centre.

- A. Walking the east section of The Grove is a delight in itself. Its own green margins and the trees overhanging from the adjacent gardens make it a wildlife corridor from the Dene into built up Jesmond. It is an extension of the Jesmond Dene green lung and a major asset to the people of Newcastle.
It is not just a matter of Right of Way but of the enrichment of life.
For example when I walk from this address through the Dene to appointments at The Freeman Hospital I choose to use The Grove rather than Grosvenor Avenue because it is more beautiful.
- B. It has been common for parts of the margins each side of the path to be made into little gardens in themselves, with no suggestion of division from the land of the Right of Way. I have long assumed that some very public spirited householders on Grosvenor Avenue delight in offering these tiny informal gardens to the public, in the same spirit sometimes seen in back lanes elsewhere.
- C. Since I first knew The Grove some high garden fences on its south side have been moved out onto The Grove, reducing the public space and increasing private garden sizes. I believe 38-42 Grosvenor Avenue have done so.

No doubt it is too late to reverse past appropriations but I call on the City to prevent any further boundary alterations.

Yours sincerely

[Redacted signature]

[Redacted address]

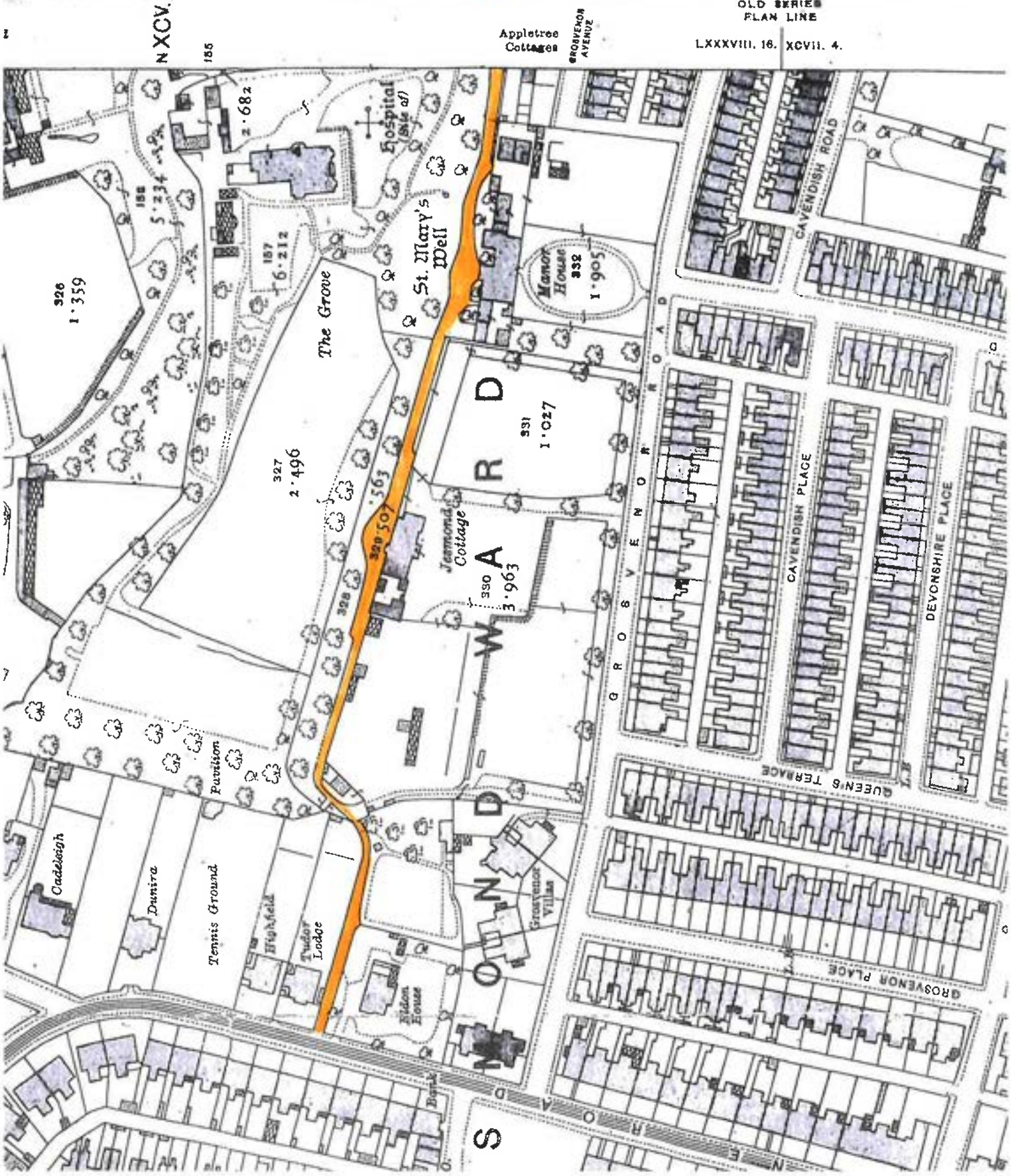
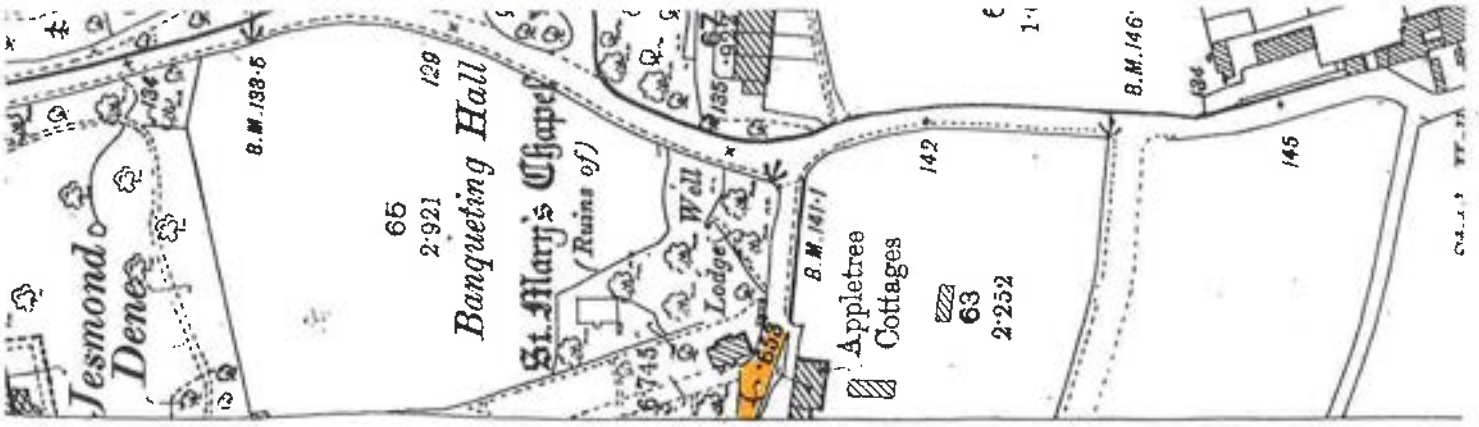

OLD SERIES
PLAN LINE

Appletree
Cottages
GROSVENOR
AVENUE

LXXXVIII. 16. XCVII. 4.



Public Right of Way User Evidence Form

About the application route

1. Is the application route:

- | | |
|--|-----|
| A footpath (public rights on foot only) | No |
| A bridleway (public rights on foot and on horseback or bicycle) | YES |
| A restricted byway (public rights on foot, on horseback or any non-motorised vehicle) | No |
| A byway open to all traffic (public rights for all classes of use, including motor vehicles) | No |

2. Describe the application route (include start and finish points and provide OS grid references if you can)

THE EASTERN LENGTH OF THE GROVE,
 THAT IS THE PART BETWEEN THE NORTH END OF QUEENS TERRACE AND
 THE WESTERN LENGTH OF THE GROVE
 TO JESMOND DENE ROAD

Map of the application route

Please attach an extract from a map of your choice (1:2500 scale if possible) and identify the exact route you are providing evidence about (draw the route on the map so it is obvious). Please annotate the map with anything you provide details about in this form, for example, the location of a gate or sign. Please put your initials on your map and date it. **Please do not add your full signature.**

3. Why do you regard this way as public?

BECAUSE IN MY EXPERIENCE SINCE 1980 IT HAS ALWAYS BEEN OPEN TO
 THE PUBLIC, USED BY THE PUBLIC ON FOOT AND BICYCLE AND IT HAS BEEN
 SIGNED BY THE LOCAL AUTHORITIES AS A ROUTE TO AMENITIES AND SCHEDULED
 MONUMENTS.

I HAVE OFTEN STOOD ASIDE TO LET PASS OTHER WALKERS, DOG WALKERS AND
 CYCLISTS. IT HAS NEVER BEEN CLOSED OR OVERGROWN FOR LACK OF
 PUBLIC USE. IT HAS PUBLIC STREET LIGHTING

Your use of the application route

4. In which years did you use the application route?

From 1980 To 2023

5. Were there any extended periods during which you did not use the route at all? If so, please state when and why?

NO

6. How did you use the application route and how often? [Please tick any that apply]

	Daily	Weekly	Monthly	Every few months	Once a year	Other (please describe)
On foot		✓	✓			
On horseback						
By pedal cycle						<u>OCCASIONAL</u>
By motor vehicle						
By horse-drawn vehicle						

7. Where were you going, and for what purpose?

ALONG JESMOND OENE FOR RECREATION OR ACROSS THE OENE FOR WORK,
OR TO VISIT FAMILY OR TO GO TO FREEMAN HOSPITAL

8. Has the application route always followed the same course?

Yes ✓

No

If no – how and when was the route altered?

9. Approximately how wide is the application route?

[Please give your estimate of the width across which you used the route including the width used when passing others or walking with others. Take care to consider the overall width of the route. If this varies, please describe how. Or please state 'don't know']

VARIES BETWEEN ABOUT 4 m AND 1 m WHERE IT HAS BEEN NARROWED BY RAILINGS NORTH OF 52 ~~OSBORNE~~ GROSVENOR AVENUE

10. What type of surface does the application route have? (for example grass, gravel, earth)

[Are there any changes along its length]

AT THE WEST END LOOSE BROKEN STONE SHARED WITH VEHICLE ACCESS TO 'THE HOUSE' AND 'GROSVENOR HOUSE'. THE REMAINDER A HARD BROKEN STONE PATH BETWEEN GREEN MARGINS

11. Have there ever been any of the following on the application route?

Stiles [state locations and show on your map]

No

How long were they in place?

Gates [state locations, indicate whether locked – and when – and show on your map]

No

Other barriers [state what they were and location, how long they were in place and show on your map]

No

12. Did any of the above prevent you from using the application route?

No

N/A APPLICABLE

Yes

If yes, please give details

13. Have you ever seen any signs or notices suggesting whether or not the application route is a public right of way? (for example "Private", "Keep Out", "No Right of Way" "Trespassers will be Prosecuted")

No ✓

Yes

If yes – state when and give details, including when they were present and mark their location on your map

.....
.....
.....

14. Have you seen other people using the application route whilst you have been using it?

No

Yes ✓

If yes, please provide any additional information about this

.....
COMMONLY OTHER WALKERS, DOG WALKERS AND CYCLISTS
USE THE PATH AT THE SAME TIME
.....
.....

Land Ownership

15. Were you working for any owner or occupier of land crossed by the application route at the time when you used it, or were you then a tenant / licensee of any such owner?

No ✓

Yes

16. Did the owner or occupier ever give you permission (or did you seek permission) to use the application route?

No ✓

Yes

17. Has anyone ever told you the application route was not public (including by an owner, tenant of the land or by anyone in their employment)?

No ✓

Yes

18. Have you ever been stopped or turned back when using the application route?

No



Yes

If yes, by whom and when?

.....
.....
.....

19. Has anyone else ever told you that they were prevented from using the application route?

No



Yes

If yes, please give details including when this happened

.....
.....
.....

20. Have you ever had a private right to use the application route? (for example, an easement, private right of access, licence, etc)

No



Yes

If yes, please give full details, including who gave the permission, why and when

.....
.....
.....

Other Information

21. Do you have, or do you have knowledge of, any documentary evidence which is relevant to the application route or which indicates public use? (for example photographs, guidebooks, letters, sale documents, old maps, etc)

No

Yes



If yes – please provide details

..... PLEASE SEE ENCLOSED LETTER 29 JULY 2023 AND ENCLOSURES

.....
.....
.....
22. Please give any further information which you consider would be helpful in reaching a decision as to whether the application route should be recorded as a public right of way?

[Continue on a separate sheet if necessary]

[If you wish to provide additional sketch map or drawings, please do so and attach to this statement]

SEE ENCLOSED LETTER 29 JULY 2023

.....
.....
.....
.....
.....
.....
.....
.....
.....
.....
23. During the investigation an officer from the Newcastle City Council may want to talk to or informally interview some or all of the users in order to gather additional information. Would you be willing to provide further information about your knowledge of the application route?

Yes



No

24. Would you be willing to attend a hearing, or public inquiry to give evidence if necessary?

Yes



No

Please make sure you have completed your contact details on pages i, and read the Data Protection information and signed the Statement of Truth on page ii.

Please remember to enclose a map showing the precise line of the route used.

This completed form plus any supporting evidence should either be returned to the person making the application, or if requested (if an application has already been submitted) direct to:

**Public Rights of Way
Place Directorate – Transport
Newcastle City Council
10th Floor, Civic Centre
Barras Bridge
Newcastle upon Tyne
NE1 1QH
Email: prow@newcastle.gov.uk**

Thank you for taking the time to complete this form.



Existing public highway (indicative only)

Plan to accompany User Evidence Form
Please draw clearly on the plan the route you have used, preferably in bold black

Scale: 1:1,500 at A4
Please insert initial and date:

Scale bar: 0 10 20 40 Meters

For official use only

Initials: [REDACTED]

Date: 29 JULY 2023

Ref: 18.

Public Right of Way User Evidence Form

About the application route

1. Is the application route:

- A footpath (public rights on foot only) **A footpath**
- A bridleway (public rights on foot and on horseback or bicycle)
- A restricted byway (public rights on foot, on horseback or any non-motorised vehicle)
- A byway open to all traffic (public rights for all classes of use, including motor vehicles)

2. Describe the application route (include start and finish points and provide OS grid references if you can)

This is the footpath between Osborne Road, Jesmond and the bottom of Reid Park Road. The footpath is known as The Grove

.....

.....

.....

.....

.....

.....

.....

Map of the application route

Please attach an extract from a map of your choice (1:2500 scale if possible) and identify the exact route you are providing evidence about (draw the route on the map so it is obvious). Please annotate the map with anything you provide details about in this form, for example, the location of a gate or sign. Please put your initials on your map and date it. **Please do not add your full signature.**

3. Why do you regard this way as public?

The western end which leads from Osborne Road is surfaced and marked for pedestrians and cyclists. The longer eastern section is well walked, has lighting and no obstructions, leads to a site of historical interest. does not appear to pass through any private land and has all the appearance of not only a footpath but a Right of Way, as many people assume it to be.

.....

Your use of the application route

4. In which years did you use the application route?

From 1988 To 2023

5. Were there any extended periods during which you did not use the route at all? If so, please state when and why?

No

6. How did you use the application route and how often? [Please tick any that apply]

	Daily	Weekly	Monthly	Every few months	Once a year	Other (please describe)
On foot			Yes			
On horseback						
By pedal cycle						
By motor vehicle						
By horse-drawn vehicle						

7. Where were you going, and for what purpose?

Usually when walking to or from our home to Jesmond Dene, often as a more interesting alternative to

 walking down Reid Park Road. In more recent years I have also used this route leading for walks for local

 history groups, walking groups and for walks during Jesmond Festival. This is because of its historic interest.

8. Has the application route always followed the same course?

- Yes **YES**
- No

If no – how and when was the route altered?

.....

9. Approximately how wide is the application route?
[Please give your estimate of the width across which you used the route including the width used when passing others or walking with others. Take care to consider the overall width of the route. If this varies, please describe how. Or please state 'don't know']

It is over three metres wide, particularly through the eastern and western thirds of the route. In the middle section the footpath is much narrower because of what appear to be "encroachments" into the footpath where the width of the path no longer follows the line of the old stone wall because fencing has been erected

10. What type of surface does the application route have? (for example grass, gravel, earth)
[Are there any changes along its length]

The western section has been surfaced for about 200 metres to Queen's Terrace. The remaining section was probably given a gravel-type surface some decades ago, but this has largely worn away.

11. Have there ever been any of the following on the application route?

Stiles [state locations and show on your map]

No

How long were they in place?

Gates [state locations, indicate whether locked – and when – and show on your map]

There are what appear to be stone gateposts at the eastern end, which may have been for regulating access to the old manor house. This was almost a century ago.

Other barriers [state what they were and location, how long they were in place and show on your map]

None

12. Did any of the above prevent you from using the application route?

No No

Yes

If yes, please give details

13. Have you ever seen any signs or notices suggesting whether or not the application route is a public right of way? (for example "Private", "Keep Out", "No Right of Way" "Trespassers will be Prosecuted")

No **No**

Yes

If yes – state when and give details, including when they were present and mark their location on your map

.....

I became aware because of an earlier planning application notice that a householder on Grosvenor Avenue wanted the footpath closed

.....

14. Have you seen other people using the application route whilst you have been using it?

No

Yes **Yes, all the time**

If yes, please provide any additional information about this

It is commonly and frequently used as a Right of Way by walkers between Osborne Road or Queen's Terrace and Jesmond Dene Road

.....

.....

Land Ownership

15. Were you working for any owner or occupier of land crossed by the application route at the time when you used it, or were you then a tenant / licensee of any such owner?

No **No**

Yes

16. Did the owner or occupier ever give you permission (or did you seek permission) to use the application route?

No **No**

Yes

17. Has anyone ever told you the application route was not public (including by an owner, tenant of the land or by anyone in their employment)?

No **No**

Yes

18. Have you ever been stopped or turned back when using the application route?

No **No**

Yes

If yes, by whom and when?

.....
.....
.....

19. Has anyone else ever told you that they were prevented from using the application route?

No **No, but it became known that there was a threat of closure**

Yes

If yes, please give details including when this happened

.....
.....
.....

20. Have you ever had a private right to use the application route? (for example, an easement, private right of access, licence, etc)

No **No**

Yes

If yes, please give full details, including who gave the permission, why and when

.....
.....
.....

Other Information

21. Do you have, or do you have knowledge of, any documentary evidence which is relevant to the application route or which indicates public use? (for example photographs, guidebooks, letters, sale documents, old maps, etc)

No

Yes **Yes**

If yes – please provide details

The route is shown on OS maps for 1913, 1895 and 1859. It is known to have been part of an old footpath
.....
originally branching from Friday Fields Lane and taking a route eastwards to Jesmond Manor House and

Jesmond Dene

.....

.....

.....

22. Please give any further information which you consider would be helpful in reaching a decision as to whether the application route should be recorded as a public right of way?
[Continue on a separate sheet if necessary]
[If you wish to provide additional sketch map or drawings, please do so and attach to this statement]

.....

.....

.....

.....

.....

.....

23. During the investigation an officer from the Newcastle City Council may want to talk to or informally interview some or all of the users in order to gather additional information. Would you be willing to provide further information about your knowledge of the application route?

- Yes **Yes**
- No

24. Would you be willing to attend a hearing, or public inquiry to give evidence if necessary?

- Yes **Yes**
- No

Please make sure you have completed your contact details on pages i, and read the Data Protection information and signed the Statement of Truth on page ii.

Please remember to enclose a map showing the precise line of the route used.

This completed form plus any supporting evidence should either be returned to the person making the application, or if requested (if an application has already been submitted) direct to:

**Public Rights of Way
Place Directorate – Transport
Newcastle City Council
10th Floor, Civic Centre
Barras Bridge
Newcastle upon Tyne
NE1 1QH
Email: prow@newcastle.gov.uk**

Thank you for taking the time to complete this form.

Mr Nick Howell
Place Directorate – Transport
Newcastle City Council
10th Floor Civic Centre
Barras Bridge
Newcastle Upon Tyne
NE1 1QH

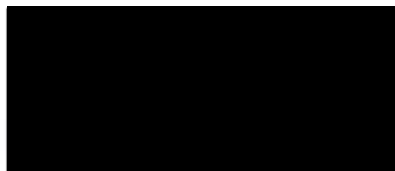

Previously owner of



7 August 2023

Dear Mr Howell,

'The Grove' – evidence in support of Definitive Map Modification Order Application

Thank you very much for your letter dated 24 July 2023 which has been re-directed by Royal Mail to my new address [REDACTED]. I have been a resident of [REDACTED] Jesmond - Newcastle Upon Tyne – NE2 2PL for 41 years until 30 March 2023 when I sold my house to [REDACTED].

Although you may not consider my letter regarding The Grove now, I feel that it is important to get in touch with you about the above matter. Some of the houses in Grosvenor Avenue have been transformed in HMOs and their owners want to integrate in their property the path called 'The Grove' which separate the back of their HMOs from their gardens.

I understand that 'The Grove' has been used for centuries by pilgrims visiting St Mary's well and I certainly used it regularly over 41 years to go down or up from the end of Queens Terrace to Jesmond Dene Park as it is a very picturesque path away from the car traffic on Grosvenor Avenue. It would be sad if the residents of Jesmond were to lose right of access to this lovely path as it is a safe way for adults and children to walk along behind the houses in Grosvenor Avenue.

I hope that as the Public Rights of Way Officer you will be able to support with Newcastle City Council that 'The Grove' is protected for the good of the community and becomes an officially recognised path for all pedestrians.

I look forward to hearing that the "Definitive Map Modification Application" has been agreed by Newcastle City Council. My old neighbours will certainly keep me informed.

With my thanks for your consideration.

Yours sincerely,



[REDACTED]

P.S. Please excuse me for using a blue pen instead of a black pen.

Public Right of Way User Evidence Form

About the application route

1. Is the application route:

A footpath (public rights on foot only)

I think the path should only be for pedestrians.

A bridleway (public rights on foot and on horseback or bicycle)

A restricted byway (public rights on foot, on horseback or any non-motorised vehicle)

A byway open to all traffic (public rights for all classes of use, including motor vehicles)

2. Describe the application route (include start and finish points and provide OS grid references if you can)

The GROVE - The path goes from Queens Terrace to Jesmond Dene Road ^{between} the back of the houses in Grosvenor Avenue and their gardens.

Map of the application route

Please attach an extract from a map of your choice (1:2500 scale if possible) and identify the exact route you are providing evidence about (draw the route on the map so it is obvious). Please annotate the map with anything you provide details about in this form, for example, the location of a gate or sign. Please put your initials on your map and date it. **Please do not add your full signature.**

3. Why do you regard this way as public?

1 It allows access to St Mary's well, an old pilgrimage's place

2 It leads from Queens Terrace to Jesmond Dene Road avoiding road traffic

Your use of the application route

4. In which years did you use the application route?

From September 1982 To March 2023

5. Were there any extended periods during which you did not use the route at all? If so, please state when and why?

.....

.....

.....

6. How did you use the application route and how often? [Please tick any that apply]

	Daily	Weekly	Monthly	Every few months	Once a year	Other (please describe)
On foot			✓			twice a month
On horseback						
By pedal cycle						
By motor vehicle						
By horse-drawn vehicle						

7. Where were you going, and for what purpose?

I was going for a walk to Jesmond Dene Park or coming back from a walk to in Jesmond Dene Park to my house in Queens Terrace

8. Has the application route always followed the same course?

Yes

~~No~~

If no – how and when was the route altered?

.....

.....

9. Approximately how wide is the application route?
[Please give your estimate of the width across which you used the route including the width used when passing others or walking with others. Take care to consider the overall width of the route. If this varies, please describe how. Or please state 'don't know']

It is about 1 metre wide allowing 2 people to walk side by side or behind each other

10. What type of surface does the application route have? (for example grass, gravel, earth)
[Are there any changes along its length]

grass and compacted soil as people are walking on this path

11. Have there ever been any of the following on the application route?

Stiles [state locations and show on your map]

/

How long were they in place?

/

Gates [state locations, indicate whether locked – and when – and show on your map]

/

Other barriers [state what they were and location, how long they were in place and show on your map]

/

12. Did any of the above prevent you from using the application route?

No

Yes

If yes, please give details

.....

13. Have you ever seen any signs or notices suggesting whether or not the application route is a public right of way? (for example "Private", "Keep Out", "No Right of Way" "Trespassers will be Prosecuted")

No

Yes

If yes – state when and give details, including when they were present and mark their location on your map

.....

.....

.....

14. Have you seen other people using the application route whilst you have been using it?

No

Yes

If yes, please provide any additional information about this

People were walking up or down the path to or from Jernodene Park

Land Ownership

15. Were you working for any owner or occupier of land crossed by the application route at the time when you used it, or were you then a tenant / licensee of any such owner?

No

Yes

16. Did the owner or occupier ever give you permission (or did you seek permission) to use the application route?

No

Yes

17. Has anyone ever told you the application route was not public (including by an owner, tenant of the land or by anyone in their employment)?

No

Yes

.....
.....
.....
22. Please give any further information which you consider would be helpful in reaching a decision as to whether the application route should be recorded as a public right of way?

[Continue on a separate sheet if necessary]

[If you wish to provide additional sketch map or drawings, please do so and attach to this statement]

As already mentioned I used the route for 41 years on a regular basis; it is a lovely path which deserves been shared with the community.

23. During the investigation an officer from the Newcastle City Council may want to talk to or informally interview some or all of the users in order to gather additional information. Would you be willing to provide further information about your knowledge of the application route?

Yes

No

I am now living in France but would try my best to answer to an email

24. Would you be willing to attend a hearing, or public inquiry to give evidence if necessary?

Yes

No

This may prove too difficult for me as I now reside in France

Please make sure you have completed your contact details on pages i, and read the Data Protection information and signed the Statement of Truth on page ii.

Please remember to enclose a map showing the precise line of the route used.

This completed form plus any supporting evidence should either be returned to the person making the application, or if requested (if an application has already been submitted) direct to:

**Public Rights of Way
Place Directorate – Transport
Newcastle City Council
10th Floor, Civic Centre
Barras Bridge
Newcastle upon Tyne
NE1 1QH
Email: prow@newcastle.gov.uk**

Thank you for taking the time to complete this form.

Jesmond The GROVE from Queens Terrace to Jesmond Dene Road

Ky: 3MM06

ewcastle
City Council

ewcastle City Council
1 Floor, Civic Centre
Gas Bridge
ewcastle upon Tyne
11QH



existing public
pathway
(indicative only)

Plan to accompany User Evidence Form

Please draw clearly on the plan the route
you have used, preferably in bold black

Scale: 1:1,500 at A4

Please initial and date:

Initials: [REDACTED]

Scale bar: 0 10 20 40 Meters

Date: **07.08.2023**

For official use only

Ref: 20.

ONE DAY MY PRINTER WILL COME...

COVERING LETTER.

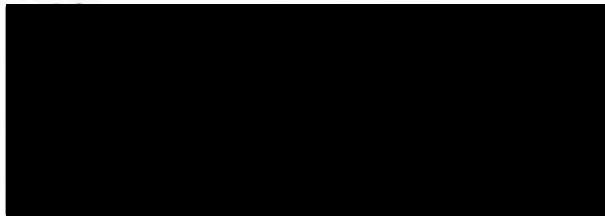

JESMOND,
NICE &
NE2 2NN.

BT DISCONNECTED MY LANDLINE BECAUSE } OF THEIR MANAGERIAL INCOMPETANCE } PTEL - SEE BELOW SEPTEMBER. 2023

THE GROVE/PILGRIMS WAY. 14th/2023

PUBLIC RIGHT OF WAY ISSUE.

COPIES OF MY SUBMISSION (I TO VIII)
- CONTENTS LIST PTO.

COPIES OF THIS LETTER + CONTENTS (I TO VIII)
ENCLOSED.

TO: - NICK HOWELL PUBLIC RIGHTS OF WAY OFFICER - PTO. SEE II.

AND JESMOND RESIDENTS ASSOC.
40 THE SECRETARY
NILES CLEMMEYSON
3, BEMERSIDE DRIVE, (Jesmond)
NE2 2HL.

TO RING ME: - RING [REDACTED] (SMARTPHONE).
BUT - YOUR PHONE WILL PROBABLY PRETEND THE NUMBER IS [REDACTED].
BUT DON'T RING IT UNLESS YOU CAN'T GET THRU (RING LEAVING A MESSAGE ON 1603...)

STILL NO PRINTER!

I LIST OF CONTENTS.

JESMOND,
N/le & NE2.2NN.
V. [REDACTED]

⊗ DATES. 2.11
+ REFS. 2.11

LIST OF CONTENTS.

II (N.B. ALL PARAGRAPHS "§" INDICATED BY NUMBERS IN □'S eg [N] - AND SEPARATE ENCLOSED DOCUMENTS. MARKED WITH ROMAN NUMERALS AS WELL AS TITLES - EG. "I-LIST OF CONTENTS"

II [2] LETTER FROM NICK HOWELL (PUBLIC RIGHTS OF WAY OFFICER)

III PUBLIC RIGHT OF WAY USER EVIDENCE FORM (1st PART) INC. DECLARATION/SIGNATURE.

IV PUBLIC RIGHT OF WAY USER EVIDENCE FORM (2nd PART) INC. MAP.

V COPY LETTER TO NILS OF JESMOND RESIDENTS ASSOC SITE INSPECTION REPORT.

VI 1st ADDENDUM.

VII 2nd ADDENDUM.

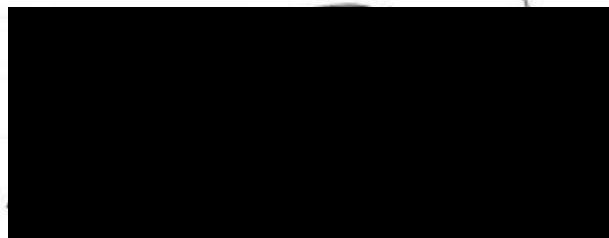

14/9/23

N.B. I HAVE JUST REMEMBERED: "THIS PUBLIC RIGHT OF WAY HAS BEEN USED AS SUCH" SINCE TIME IMMEMORIAL



The person dealing with this matter is:
Nick Howell
Place Directorate - Transport
Newcastle City Council
10th Floor Civic Centre
Barras Bridge
Newcastle upon Tyne, NE1 1QH

II

Phone: 0191 277 1184
Email: nick.howell@newcastle.gov.uk
www.newcastle.gov.uk

*Deadline
"ASAP"
No. Inquiry date.*



Jesmond
Newcastle upon Tyne
NE2 2NN
Our reference: DMMO6

0000362 NEWCC_00053



24 July 2023

P. 1 "3"

*Complete - dated signature
P. 3 - "10" * P. 5 "21" * P. 6 "22" "P. ii"*

'The Grove' – evidence in support of Definitive Map Modification Order Application

Dear

2

I am writing to you in connection with the December 2021 application made by Jesmond Residents Association (JRA) to add a route known as 'The Grove' to the Definitive Map and Statement (legal record of public rights of way). Apologies for the delay in progressing this application. The Council was without a Public Rights of Way Officer for much of 2022.

3

In March 2021 you completed and signed a single page document which was forwarded to the Council by the JRA as supporting evidence of the public's use of the route. Some 50+ of these documents from local residents were provided. The document described your number of years of uninterrupted use of the route but unfortunately did not allow for providing other details which can be important when investigating the evidence and determining the application.

4

I have enclosed a blank User Evidence Form and would be grateful if you could complete and return this along with the enclosed plan at your earliest convenience. You are welcome to use the prepaid envelope, or if preferred send a scanned copy to me via email.

5

The Council welcomes any evidence you wish to submit which would support the applicant's claim. So should you have any additional supporting evidence then I would be happy to view these items and you are welcome to contact me to discuss these. The Council is intending to determine the application later this year and we may wish to take more detailed statements from the information being provided.

6

I look forward to hearing from you. In the meanwhile should you have any queries then please let me know.

Yours sincerely

**Nick Howell
Public Rights of Way Officer**

Public Right of Way User Evidence Form

About the application route

1. Is the application route:

- A footpath (public rights on foot only) **TO MY KNOWLEDGE FOR ABOUT 70 YRS**
- A bridleway (public rights on foot and on horseback or bicycle)
- A restricted byway (public rights on foot, on horseback or any non-motorised vehicle)
- A byway open to all traffic (public rights for all classes of use, including motor vehicles)

NOT TO MY KNOWLEDGE BUT

2. Describe the application route (include start and finish points and provide OS grid references if you can)

3. THE EASTERN END, WHICH IS SURFACED (STARTED) WAS USED AS A ROAD FOR MOTOR ETC VEHICLES "FILL" BOLLARDED OFF TO PROTECT JESMOND DENE ROAD FROM FALLING INTO JESMOND DENE. THAT ROAD QUALITY PART IS STILL USED BY VEHICLES EG ACCESSING THE WALLS/ST. MARY'S WOOD.

"ST. MARY'S WELL" EVIDENCE HORSE (ETC) USE FOR MANY HUNDREDS OF YEARS - SEE HISTORICAL (ARCHIVE) EVIDENCE.

4. Please attach an extract from a map of your choice (1:2500 scale if possible) and identify the exact route you are providing evidence about (draw the route on the map so it is obvious). Please annotate the map with anything you provide details about in this form, for example, the location of a gate or sign. Please put your initials on your map and date it. Please do not add your full signature.

MAP: [4b] - SEE END.

3. Why do you regard this way as public?

PLEASE SEE ALL THE EVIDENCE AND INFERENCE CONTAINED IN THIS FORM AND ALL THE ATTACHED DOCUMENTS ["ROMAN NUMERALS" SEE CONTENTS LIST OF CONTENTS - I] TO ALL OF WHICH [11] ie ABOVE APPLIES, & ie "DECLARATION AND SIGNATURE"

Your use of the application route .

6

4. In which years did you use the application route?

From ABOUT 1952 To ABOUT 2012

7

5. Were there any extended periods during which you did not use the route at all? If so, please state when and why?

(AND OCCASIONALLY THEREAFTER)
 ONLY FOLLOWING KNEE INJURIES AND SERIOUS ILLNESS CAUSED BY ADVERSE REACTION TO ANTI-INFLAMATORIES - BUT OCCASIONAL USE CONTINUES AND INCREASES AS MY KNEES RECOVER

8

6. How did you use the application route and how often? (Please tick any that apply)

	Daily	Weekly	Monthly	Every few months	Once a year	Other (please describe)
On foot		✓ AND OR ✓				
On horseback						
By pedal cycle						
By motor vehicle						
By horse-drawn vehicle						

9

7. Where were you going, and for what purpose?

WALKING TO VISIT IESMOND DENE, AND/OR (MORE RECENTLY) "TOUR GUIDING" FRIENDS. (AND/OR ST. MARY'S WELL/WOOD/POND/CHAPEL.

10

8. Has the application route always followed the same course?

Yes (SUBJECT TO (?) SLIGHT VARIATION BEHIND "BIG HOUSE" AT WEST END OF ROUTE - BUT THIS IS ONLY SLIGHTLY NARROWER - RIGHT ANCIENT RIGHT-OF-WAY/

If no - how and when was the route altered?

BUT SEE OTHER DOCUMENTS FOR ADDITIONAL COMMENT 2

9. Approximately how wide is the application route?

[Please give your estimate of the width across which you used the route including the width used when passing others or walking with others. Take care to consider the overall width of the route. If this varies, please describe how. Or please state 'don't know']

AS SHOWN ON PLAN/MAP PROVIDED. SEE "SITE INSPECTION".

HOWEVER, SOME VEGETATION DOES NEED CUTTING BACK, BUT OTHERWISE WIDE ENOUGH FOR 2 PEOPLE.

10. What type of surface does the application route have? (for example grass, gravel, earth) [Are there any changes along its length]

PLEASE SEE "SITE INSPECTION" ETC.

11. Have there ever been any of the following on the application route?

Stiles [state locations and show on your map] NO.

How long were they in place? N/A.

Gates [state locations, indicate whether locked – and when – and show on your map] N/A.

Other barriers [state what they were and location, how long they were in place and show on your map] N/A.

12. Did any of the above prevent you from using the application route?

No N/A.

If yes, please give details N/A.

15

13. Have you ever seen any signs or notices suggesting whether or not the application route is a public right of way? (for example "Private", "Keep Out", "No Right of Way" "Trespassers will be Prosecuted")

No SUBJECT TO THE COUNCIL'S SIGN AT THE NORTH/GOOD CUL-DE-SAC END OF QUEEN'S TERRACE
Yes SAYING "THE GRAVE GROVE" WITH ARROWS POINTING W AND E
N/A

If yes - state when and give details, including when they were present and mark their location on your map

16

14. Have you seen other people using the application route whilst you have been using it?

No
Yes

If yes, please provide any additional information about this

FREQUENTLY, EITHER WHEN I USED IT, OR WHEN I WAS AT THE SESOND DENC END, OR AT THE WEST END. AND SEE DETAILED NARRATIVE.

Land Ownership

17

15. Were you working for any owner or occupier of land crossed by the application route at the time when you used it, or were you then a tenant / licensee of any such owner?

No SUBJECT TO LAND IMMEDIATELY BEHIND MY HOUSE NOW ADOPTED AS PART OF REID PK ROAD.
Yes

18

16. Did the owner or occupier ever give you permission (or did you seek permission) to use the application route?

No } N/A
Yes

19

17. Has anyone ever told you the application route was not public (including by an owner, tenant of the land or by anyone in their employment)?

No
Yes

SEE:- "NEC.VI, NEC.CLAM, NEC.PRECAPIO"

18. Have you ever been stopped or turned back when using the application route?

No
 Yes
20

If yes, by whom and when?
N/A

.....
.....
.....

19. Has anyone else ever told you that they were prevented from using the application route?

No
 Yes
21

If yes, please give details including when this happened

.....
.....
.....

20. Have you ever had a private right to use the application route? (for example, an easement, private right of access, licence, etc)

No BUT SEE 17 ABOVE.
 Yes

If yes, please give full details, including who gave the permission, why and when

.....
.....
.....

Other Information

21. Do you have, or do you have knowledge of, any documentary evidence which is relevant to the application route or which indicates public use? (for example photographs, guidebooks, letters, sale documents, old maps, etc)

No
 Yes
RE-EXAMINE DEEDS/LEASES/RESERVATIONS

If yes - please provide details

SEE VIII AND OTHER COMMENTS IN MY NARRATIVE.

.....
.....
.....

22 Please give any further information which you consider would be helpful in reaching a decision as to whether the application route should be recorded as a public right of way?

[Continue on a separate sheet if necessary]

[If you wish to provide additional sketch map or drawings, please do so and attach to this statement]

24

HISTORICAL/GEOGRAPHICAL! SEE BELOW
- SEE DETAILED NARRATIVE.

THE TOTALITY OF MY RESPONSE HAS
CAUSED ME TO BELIEVE THAT "THE GROVE"
/ "PILGRIM'S WAY" HAS BEEN A PUBLIC RIGHT OF
WAY AND USED AS SUCH "SINCE TIME IMMEMORIAL"

23. During the investigation an officer from the Newcastle City Council may want to talk to or informally interview some or all of the users in order to gather additional information. Would you be willing to provide further information about your knowledge of the application route?

Yes

No

25

24. Would you be willing to attend a hearing, or public inquiry to give evidence if necessary?

Yes

No

26

Please make sure you have completed your contact details on pages i, and read the Data Protection information and signed the Statement of Truth on page ii.

Please remember to enclose a map showing the precise line of the route used.

This completed form plus any supporting evidence should either be returned to the person making the application, or if requested (if an application has already been submitted) direct to:

Public Rights of Way
Place Directorate - Transport
Newcastle City Council
10th Floor, Civic Centre
Barras Bridge
Newcastle upon Tyne
NE1 1QH
Email: prow@newcastle.gov.uk



14/9/23

Thank you for taking the time to complete this form.

ST. MARYS POND @ ST. MARYS WOOD @ HADSPUR ASUBHICULAL ROAD

Newcastle City Council
Newcastle City Council
10th Floor, Civic Centre
Barras Bridge
Newcastle upon Tyne
NE1 1QH



Existing public highway (indicative only)

Plan to accompany User Evidence Form
Please draw clearly on the plan the route you have used, preferably in bold black

Scale: 1:1,500 at A4
Please initial and date

Scale bar: 0 10 20 40 Meters

For official use only

Initials: [Redacted]

Date: 14/9/23

Ref: 21.

N.B. I NO LONGER

[REDACTED] (1)
JESMOND,
Newcastle upon Tyne
NE2 2NN
~~T. 0191 201000~~ (X)

DATE
14/9/23
[2]

FOR THE FOLLOWING

DEAR NILS,
re "THE GROVE"
("PILGRIMS WAY")
PUBLIC RIGHT OF WAY

V

[3] I ENCLOSE A PHOTOCOPY OF MY LETTER FROM NICK HOWELL AND MY COMPLETED "PUBLIC RIGHT OF WAY USER EVIDENCE FORM."

BECAUSE OF LACK OF SPACE, I ADD TO P2, (5) :- I HAVE LIVED

HERE FOR
APPROX. 40 YRS, AND DURING THAT TIME I HAVE VERY FREQUENTLY (ie ALMOST DAILY!) SEEN PEOPLE USING THE RIGHT OF WAY IMMEDIATELY BEHIND MY HOUSE (ie TO THE NORTH) BUT ONLY OCCASIONALLY PROCEEDING TO OR FROM THAT "WAY" TO OR FROM REID PARK ROAD. N.B. BECAUSE OF THE LOCAL GEOGRAPHY / TOPOGRAPHY I ONLY SEE THE UPPER PARTS OF THEIR BODIES IMMEDIATELY BEHIND MY HOUSE NEARBY REID PARK ROAD AND

UNDERLINED
"ONLY FROM MY CONSERVATORY"

USERS ARE EASILY SEEN: (2)
FURTHER WEST UP THE GROVE
USERS ARE OUT OF SIGHT
BUT THEY MUST BE TRAVERSING
IT UNLESS THEY ARE ABDUCTED
OR DEPOSITED BY ALIENS.....
IN B.I.A.M. A. "TRAG".....
A FEW PEOPLE MAY OCCASIONALLY
ENTER OR EXIT FROM IT
VIA BACK GARDEN DOORS/GATES
→ BUT I DON'T RECALL SEEING
NEIGHBOURS AND GROSVENOR
AV. IS AN EASIER ROUTE.

2 CONT

3) WHEN GOING FROM GROSVENOR
AV. ON FOOT VIA QUEEN'S TCE.
TO THE WESTWARD CONTINUATION
OF "THE GROVE" / PILGRIMS WAY
TO OSBORN ROAD — OR RETURN
RETURNING — I FREQUENTLY
SEE PEOPLE USING "THE GROVE".
(EAST) IN BOTH DIRECTIONS, AND USUALLY
GOING TO OR COMING FROM
OSBORN ROAD BY THE
WESTWARD EXTENSION.
I USUALLY MAKE THIS JOURNEY
AT LEAST ONCE A WEEK — OR
MORE OFTEN.

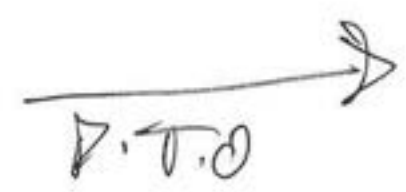

PLEASE SEE MY "SITE INSPECTION" NOTE OF 10/8/23 3

5) N.B. "NOT NEXT DOOR NEIGHBOURS"
TELL ME THAT THERE USED TO BE
A HOSPITAL NORTH OF GROVE EAST
AND WEST OF ST. MARY'S CHAPEL,
WHICH WAS EXCAVATED IN THE
EARLY YEARS OF THE 20TH BEFORE
HOUSES WERE BUILT ON THE SITE.
PERHAPS N/CE U/M. HISTORY/
ARCHAEOLOGY/THEOLOGY DEPTS.
AND YOUR CITY/COUNTY-N/CE
AND OR NORTHUMBRIA AND
ARCHIVES HAVE RECORDS -
AND IN THE CASE OF THE
ARCHIVES OF GROVE (W. AND E.)
STH'S WELL AND CHAPEL TOGETHER
WITH OTHER LOCATIONS (ROADS -
ETC.) MENTIONED BELOW.

6) SITE INSPECTION: BECAUSE OF
THE AGE OF
THE CHAPEL I INFER THAT
W/E GROVE ("PIGGRIM'S WAY")
STH'S WELL AND "JESUS MOUNTAIN"
(JESMOND'S HIGHEST POINT),
OVERLOOKING MATHEW-GOSPEL-
BANK, NUNNERY - THE N" & A. SAGESSE
NOW A HOUSING ESTATE -
"CROSSWAY" - THEOLOGICAL? -
"FRIDAY FIELDS LANE" - ?
CORRUPTION OF "FRIARS FIELDS
LANE" AND THE NEARBY

6 CONT

RC / COFF. CHURCHES
AND HOSPITAL - SEE ABOVE -
THAT THE "PILGRIM'S WAY"
FROM LINDISFARNE PASSED
HERE, ON ITS WAY VIA JARROW
AND DURHAM CATHEDRAL (ETC)
TO WHITBY.

4

7

I CONCLUDED ON THE AVAILABLE
EVIDENCE AND ABOVE INFERENCES
THAT THE W/E GROVE / PILGRIM'S
WAY IS AT LEAST ≈ 800 YRS.
OLD - AND PROBABLY OVER 1,000:
QUITE POSSIBLY $\approx 1,500$ YRS OLD.
AND IS THEREFORE A PUBLIC
RIGHT OF WAY, OF GREAT ANTIQUITY.

8

NOTE: "NOTORIOUS FACTS"
MAY BE APPROPRIATE
"FACTS" WHICH CAN BE ADDUCED
IN EVIDENCE WITHOUT THE
CALLING OF WITNESSES OR
PRODUCTION OF "ITEMS" SUCH
AS DOCUMENTS, ETC.

THE CLASSIC EXAMPLE IS THAT
"GAMBLING IS LEGAL IN
MONTE CARLO". YOU DON'T
NEED TO CALL A CROUPIER!

9

[BEFORE THE ABOVE CHURCHES WERE
BUILT, THE LAND, RESEMBLING
ST. GEORGE'S GREEN, BUT
OF GREATER EXTENT WOULD
HAVE MADE EXCELLENT PASTURE
FOR FRIARS AND OTHER PILGRIM'S

HÖRSES - AND OTHER CATTLE. (5)

10

I. SUGGEST CONTACTING:-
N/LE U/N - HISTORY.

ARCHAEOLOGY

LAW.

THEOLOGY.

U/NO. F. NORTHUMBRIA - EQUIVALENT
DEPTS.

DITTO. DURHAM. U/N.

11

✱

THE COFE AND RC: DIOCES.

~~FOR~~ YOUR ARCHIVES. ✱

THIS IS NOT ONLY A LOCAL MATTER
OF CONVENIENCE, BUT OF

CULTURAL AND POTENTIALLY
ECONOMIC IMPORTANCE.

TO THE LOCALITY/ACCESS.

JESMOND DENNE) BUT THE CITY
AND REGION!

N.B. SEE DISCLAIMER!

11 CONT

✱ + DURHAM LAND REGISTRY!
- AND DURHAM CATHEDRAL!!

Your Sincerely
[Signature]

12

11

10/8/23 - PILGRIMS' WAY (GROVE) 1

SITE INSPECTION VI

- [1] I. WAS PAID FOR PERSONAL SITE INSPECTIONS IN LITIGATION. BECAUSE I WITH A. FIZAS AND WAS TAUGHT MAP READING BY THE ARMY.
- [2] UNPAVED (ie NO ROAD SURFACE) EAST BOUNDARY OF THE GROVE (E) HAS DOUBLE YELLOW LINES WHICH NEED UPGRADING.
- [3] THE GROVE FULFILLS ALL THE REQUIREMENTS SET OUT IN THE LETTER AND ENCLOSURE FROM THE COUNCIL.
- [4] ST. MARY'S WELL "BLUE LOLLIPOP ON A STICK"
- SUMMARISED * REPUTED TO BE A HOLY WELL, BUT SAID BY COUNCIL TO BE LATE 17th (17th) EARLY 18th MADE INTO A BATHING PLACE. RENOVATED 19th x
- [5] BEHIND "BIG HOUSE" AND ADJACENT/RELATED PROPERTIES: THERE WOULD BE ROOM TO REROUTE THE PUBLIC RIGHT OF WAY TO THE NORTH, AND THEN BACK SOUTH TO JOIN WITH THE REST OF THE WAY. AT WHAT COST?

SITE INSPECTION CONT.

2

6

- COULD THE ^{RELEVANT} OBJECTIONING RESIDENTS GET A QUOTA - ACTION FOR UPLIFTING THE TURF AND RELAYING NEARER TO THEIR HOUSES, WITH PROVISION FOR THEIR PARKING, PRECISE RELOCATION DETAILS AT THEIR DISCRETION?

7

I WOULD HAVE NO PERSONAL OBJECTION TO SETTLE THE DISPUTE THIS WAY AMICABLY, AND "MIGHT" CONSIDER A $\frac{1}{2}$ CONTRIBUTION. - ? YES/NO. RESIDENTS COLLECTING ALSO?

8

GENERALLY, THE E. GROVE HAS EITHER AND/OR EARTH, PEBBLES, STONES, AND WHAT APPEARS TO BE SOME COBBLES.

9

AT THE WEST END, ON THE SIDE SOUTH SIDE IS OLD STONE WALLING, OF THE SAME TYPE (AND? AGE) AS ON THE CONTINUATION OF THE GROVE W. OF QUEEN'S TERRACE.

10

NOTE. THE COUNCIL'S SIGN "THE GROVE" AT THE N. CUL-DE-SAC END OF QUEEN'S TCE. IS PARALLEL TO THE END WALL AND LEADS

"THE GROVE" WITH AN ARROW EACH SIDE OF THE 2 WORDS, POINTING RESPECTIVELY W. AND E. CLEARLY THE W. $\frac{1}{2}$ IS A PUBLIC RIGHT OF WAY - AND SO EQUALLY CLEARLY

SITE INSPECTION CONT.

3

10 CONT

IS THE E 1/2.

11

JUST E. OF THE YELLOW LINES ACROSS THE E 1/2 OF THE GROVE AT ITS JUNCTION WITH QUEEN'S TCE IS A GATE AND A WALKWAY TO SOME HOUSES - AND APART FROM EASEMENTS PERSONAL TO THE OCCUPANTS, THE RESIDENTS WOULD BE DEPRIVED OF ACCESS TO A PUBLIC RIGHT OF WAY FROM THE GROVE TO REID PARK ROAD WERE IT NOT LISTED AS A PUBLIC RIGHT OF WAY, (AND VICE VERSA)

12

CLEARLY, I FEAR THE GROVE (W. ANDE) HAS BEEN USED AS A PUBLIC RIGHT OF WAY AT LEAST SINCE THE (7) ~~TH~~ SEE ABOVE - AND FOR ACCESS TO ST. MARY'S CHAPLE WHICH IS A GRADE II* LISTED BUILDING, FOR APPROX. 800 YRS, AT LEAST.

13

THE OLD STONE WALLS REFERRED TO ARE OBVIOUSLY OF CONSIDERABLE ANTIQUITY AND THIS SUPPORTS THE "ANCIENT PUBLIC RIGHT OF WAY" CLAIM.

14

I FEAR THAT IF SUCH A FREQUENTLY USED ROUTE WERE MADE RTO

SITE INSPECTION CONT.

14

14 CONT

UNAVAILABLE "LEGALLY" THEN.
SOME PEOPLE WOULD USE
FORCE TO CONTINUE TO USE IT
WITH SOME POSSIBLE RISK OF
INTERPERSONAL VIOLENCE.

15

N.B. WE HAVE NEVER
SUFFERED ANY SORT OF
ANTI-SOCIAL BEHAVIOUR.

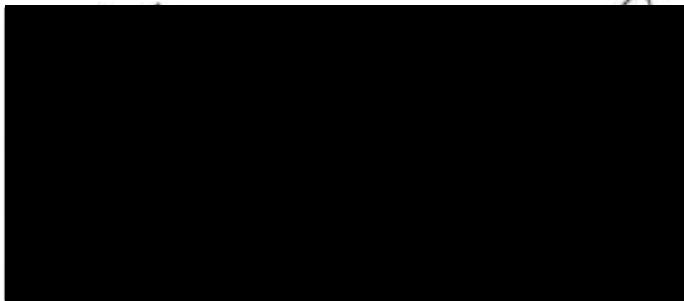

14/9/23

PUBLIC RIGHT OF WAY ^{1ST} ADDENDUM. L

VII

FURTHER DISCUSSIONS WITH NOT NEXT DOOR NEIGHBOURS

- ① a ~~1~~
11. I HAD ONLY LOOKED AT GROUND LEVEL UP TO APPROX HEADLIGHT AND FAILED TO NOTICE PROVISION OF LOCAL AUTHORITY STREET LIGHTING.
- 2 b. THE PUBLIC RIGHT OF WAY HAD BEEN "DIVERTED" [OR ORIGINALLY WAS] TO THE NORTH OF THE "BIG HOUSE" AND ITS IMMEDIATE NEIGHBOURS - THE COTTAGE AND THE 3 ~~COTTAGES~~ ^{FLATS}, ie "DOG LEGGED". [THIS COULD BE REDONE, BUT CONSIDER THE HOUSE NOW TO THE NORTH OF THIS AREA.]
- 2 a.
3. WHEN PLANNING PERMISSION WAS GIVEN FOR THE SCHOOL/BOULDERS TO USE WHAT HAD BEEN ITS PLAYING FIELDS TO THE NORTH OF THE ~~PARADE~~ ^{PUBLIC} RIGHT OF WAY TO BUILD HOUSES THERE WAS AN EXPRESS CONDITION THAT THE PUBLIC RIGHT OF WAY MUST BE PRESERVED. THIS SHOULD BE IN PLANNING DEPARTMENT ~~OR PLANNING RECORDS~~,
- 4 b. THE EXISTENCE OF THE RIGHT OF WAY OUGHT TO BE RECORDED ON/IN THE DEEDS OF THE "BIG HOUSE" AND ITS NEIGHBOURS/FLATS, WHEN THEY WERE BOUGHT BY PRESENT OWNERS.

(Public Right of Way Addendum)

(N.B. "N.R." REMINDS ME OF

5

"PILGRIM STREET" AND I
REMINDED MYSELF OF MONKWEARMOUTH
ST. OSWALDS WAY IN COUNTY DURHAM
— RELEVANT TO ANCIENT PILGRIMAGES

12

6

c. FOR THE PERIOD OF ABOUT 10 YEARS
WHEN I LIVED AT [REDACTED]

[REDACTED] IMMEDIATELY BEFORE MOVING TO
[REDACTED]

I FREQUENTLY USED THE WEST AND
EAST PARTS OF "THE GROVE" — PILGRIMS
WAY — TO AND FROM JESMOND DENE.
USE BY OTHER PEDESTRIANS WAS
OBVIOUS.

[REDACTED] 14/9/23

2nd ADDENDUM

VIII

[1] H.M. LAND REGISTRY (DURHAM)
[REDACTED]

[2] A. ORDINANCE SURVEY
PLAN REF. NZ 2566
SECTION P

[3] THE FILE PLAN DOES NOT EXTEND
BEYOND BEYOND THE BACK
GARDEN WALL OF MY HOUSE - [REDACTED]

[4] B. PROPERTY REGISTER

[5] USUAL EXCEPTIONS AND RESERV-
-ATIONS re MINES AND MINERALS
AND "ANY PART OF THE SOIL OF THE
ADJOINING ~~LAND~~ ROAD"

[6] AND USUAL BUILDING COVENANTS
"THE PURCHASER TO" (IN SHORT)
MAKE PAY FOR AND MAINTAIN THE
FRONT AND BACK STREETS -
Y2 SHARE / EACH SIDE.

[7] [BUT THE FRONT/REAR ROADS HAVE
BEEN ADOPTED].

[8] CLEARLY THE ROAD IMMEDIATELY
BEHIND [REDACTED] IS A PUBLIC RIGHT OF
WAY - AND THEREFORE BY
NECESSARY APPLICATION ALL OF W. AND EGROVE

14/9/23 [REDACTED]

Public Right of Way User Evidence Form

About the application route

1. Is the application route:

A footpath (public rights on foot only)

A bridleway (public rights on foot and on horseback or bicycle)

A restricted byway (public rights on foot, on horseback or any non-motorised vehicle)

A byway open to all traffic (public rights for all classes of use, including motor vehicles)

2. Describe the application route (include start and finish points and provide OS grid references if you can)

SEE ATTACHED MAP A-B

RUNS FROM QUEENS TERRACE TO THE GATE
PASSING BETWEEN THE BACKS OF THE HOUSES AND THE
CLEARLY SEPARATED GARDENS.

Map of the application route

Please attach an extract from a map of your choice (1:2500 scale if possible) and identify the exact route you are providing evidence about (draw the route on the map so it is obvious). Please annotate the map with anything you provide details about in this form, for example, the location of a gate or sign. Please put your initials on your map and date it. **Please do not add your full signature.**

3. Why do you regard this way as public?

THE PATH IS CLEARLY DEFINED. IT IS SEPARATED FROM THE PRIVATE
GARDEN AND YARDS ON EITHER SIDE. IT IS USED BY LOTS OF PEOPLE
IT PROVIDES ACCESS TO THE ANCIENT PILGRIMAGE SITE OF
ST. MARY'S WELL

Your use of the application route

4. In which years did you use the application route?

From 2005 To 2023

5. Were there any extended periods during which you did not use the route at all? If so, please state when and why?

ONLY WHEN I WROU'IT THERE FOR A YEAR
2022-2023

6. How did you use the application route and how often? [Please tick any that apply]

	Daily	Weekly	Monthly	Every few months	Once a year	Other (please describe)
On foot		✓				
On horseback						
By pedal cycle						
By motor vehicle						
By horse-drawn vehicle						

7. Where were you going, and for what purpose?

USUALLY AS PART OF MY EXERCISE FOR ME AND MY
PARTNER.

8. Has the application route always followed the same course?

Yes

No

If no – how and when was the route altered?

.....

9. Approximately how wide is the application route?

[Please give your estimate of the width across which you used the route including the width used when passing others or walking with others. Take care to consider the overall width of the route. If this varies, please describe how. Or please state 'don't know']

MOST OF THE ROUTE IS ABOUT 3-4 m WIDE. IT OPENS
OUT PASSING BEHIND GROSVENOR HOUSE

10. What type of surface does the application route have? (for example grass, gravel, earth)

[Are there any changes along its length]

MOSTLY EARTH. GRAVEL AT THE GROSVENOR
HOUSE END

11. Have there ever been any of the following on the application route?

Stiles [state locations and show on your map]

NO

How long were they in place?

Gates [state locations, indicate whether locked – and when – and show on your map]

NO

Other barriers [state what they were and location, how long they were in place and show on your map]

12. Did any of the above prevent you from using the application route?

No

Yes

If yes, please give details

13. Have you ever seen any signs or notices suggesting whether or not the application route is a public right of way? (for example "Private", "Keep Out", "No Right of Way" "Trespassers will be Prosecuted")

No
 Yes

If yes – state when and give details, including when they were present and mark their location on your map

.....
.....
.....

14. Have you seen other people using the application route whilst you have been using it?

No
 Yes

If yes, please provide any additional information about this

OTHER PEOPLE WALKING. USUALLY APPEAR TO BE EXERCISING THEMSELVES AND/OR DOGS
.....
.....

Land Ownership

15. Were you working for any owner or occupier of land crossed by the application route at the time when you used it, or were you then a tenant / licensee of any such owner?

No
 Yes

16. Did the owner or occupier ever give you permission (or did you seek permission) to use the application route?

No
 Yes

17. Has anyone ever told you the application route was not public (including by an owner, tenant of the land or by anyone in their employment)?

No
 Yes

18. Have you ever been stopped or turned back when using the application route?

No
 Yes

If yes, by whom and when?

.....
.....
.....

19. Has anyone else ever told you that they were prevented from using the application route?

No
 Yes

If yes, please give details including when this happened

.....
.....
.....

20. Have you ever had a private right to use the application route? (for example, an easement, private right of access, licence, etc)

No
 Yes

If yes, please give full details, including who gave the permission, why and when

.....
.....
.....

Other Information

21. Do you have, or do you have knowledge of, any documentary evidence which is relevant to the application route or which indicates public use? (for example photographs, guidebooks, letters, sale documents, old maps, etc)

No

Yes

If yes – please provide details

ATLASORGLWA.COM ENTRIES ON ST. MARY'S WELL

22. Please give any further information which you consider would be helpful in reaching a decision as to whether the application route should be recorded as a public right of way?

[Continue on a separate sheet if necessary]

[If you wish to provide additional sketch map or drawings, please do so and attach to this statement]

THE PRESENCE OF ST. MARY'S WELL - A SITE OF ALGAMBE SINCE APPARENTLY 17th CENTURY.

THIS SUGGESTS THIS ROUTE HAS THEREFORE BEEN USED FOR AT LEAST 300 HUNDRED YEARS

23. During the investigation an officer from the Newcastle City Council may want to talk to or informally interview some or all of the users in order to gather additional information. Would you be willing to provide further information about your knowledge of the application route?

Yes

No

24. Would you be willing to attend a hearing, or public inquiry to give evidence if necessary?

Yes

No

Please make sure you have completed your contact details on pages i, and read the Data Protection information and signed the Statement of Truth on page ii.

Please remember to enclose a map showing the precise line of the route used.

This completed form plus any supporting evidence should either be returned to the person making the application, or if requested (if an application has already been submitted) direct to:

Public Rights of Way
Place Directorate – Transport
Newcastle City Council
10th Floor, Civic Centre
Barras Bridge
Newcastle upon Tyne
NE1 1QH
Email: pro@newcastle.gov.uk

Thank you for taking the time to complete this form.

A



Existing public highway (indicative only)

Plan to accompany User Evidence Form
Please draw clearly on the plan the route you have used, preferably in bold black

Please initial and date:

Initials: _____

Date: _____

Scale: 1:1,500 at A4

Scale bar: 0 10 20 40 Meters

For official use only

Ref: 22.

Public Right of Way User Evidence Form

About the application route

1. Is the application route:

A footpath (public rights on foot only)

A bridleway (public rights on foot and on horseback or bicycle)

A restricted byway (public rights on foot, on horseback or any non-motorised vehicle)

A byway open to all traffic (public rights for all classes of use, including motor vehicles)

2. Describe the application route (include start and finish points and provide OS grid references if you can)

From north end of Queen's Terrace

to east end of Reid Park Road

Known as 'The Grove'

Map of the application route

Please attach an extract from a map of your choice (1:2500 scale if possible) and identify the exact route you are providing evidence about (draw the route on the map so it is obvious). Please annotate the map with anything you provide details about in this form, for example, the location of a gate or sign. Please put your initials on your map and date it. **Please do not add your full signature.**

3. Why do you regard this way as public?

It has been, and continues to be, used as a public footpath by many people every day. To my personal knowledge this has been so for over 40 years but I understand that it has been in use since antiquity to visit St Mary's Well & the Priory as well as for through passage. It forms part of the route of Pilgrimage & so has been used since antiquity.

Your use of the application route

4. In which years did you use the application route?

From 1983 To 2023

5. Were there any extended periods during which you did not use the route at all? If so, please state when and why?

None

6. How did you use the application route and how often? [Please tick any that apply]

	Daily	Weekly	Monthly	Every few months	Once a year	Other (please describe)
On foot			✓			
On horseback						
By pedal cycle					✓	
By motor vehicle						
By horse-drawn vehicle						

7. Where were you going, and for what purpose?

walking from A corn Road to Jeumont Dam
and as a circular walk from my house
to visit neighbours

8. Has the application route always followed the same course?

Yes

No

If no – how and when was the route altered?

.....

.....

9. Approximately how wide is the application route?

[Please give your estimate of the width across which you used the route including the width used when passing others or walking with others. Take care to consider the overall width of the route. If this varies, please describe how. Or please state 'don't know']

Varies, ~ 2 meters wide at narrowest point

10. What type of surface does the application route have? (for example grass, gravel, earth)

[Are there any changes along its length]

Gravel at West end; gravel and earth thereafter

11. Have there ever been any of the following on the application route?

Stiles [state locations and show on your map]

No, although a gate was erected without permission and rapidly removed adjacent to electricity sub station.

How long were they in place?

A few weeks

Gates [state locations, indicate whether locked – and when – and show on your map]

Never locked, adjacent to electricity sub station as on map

Other barriers [state what they were and location, how long they were in place and show on your map]

None

12. Did any of the above prevent you from using the application route?

No

Yes

If yes, please give details

13. Have you ever seen any signs or notices suggesting whether or not the application route is a public right of way? (for example "Private", "Keep Out", "No Right of Way" "Trespassers will be Prosecuted")

No

Yes

If yes – state when and give details, including when they were present and mark their location on your map

N.B. - the portion accessible by motor vehicles next to Grosvenor House is marked as 'Private Road'

14. Have you seen other people using the application route whilst you have been using it?

No

Yes

If yes, please provide any additional information about this

I would expect to meet several people whilst walking down the Grove

Land Ownership

15. Were you working for any owner or occupier of land crossed by the application route at the time when you used it, or were you then a tenant / licensee of any such owner?

No

Yes

16. Did the owner or occupier ever give you permission (or did you seek permission) to use the application route?

No

N/A

Yes

17. Has anyone ever told you the application route was not public (including by an owner, tenant of the land or by anyone in their employment)?

No

Yes

18. Have you ever been stopped or turned back when using the application route?

No

Yes

If yes, by whom and when?

.....
.....
.....

19. Has anyone else ever told you that they were prevented from using the application route?

No

Yes

If yes, please give details including when this happened

.....
.....
.....

20. Have you ever had a private right to use the application route? (for example, an easement, private right of access, licence, etc)

No

Yes

If yes, please give full details, including who gave the permission, why and when

.....
.....
.....

Other Information

21. Do you have, or do you have knowledge of, any documentary evidence which is relevant to the application route or which indicates public use? (for example photographs, guidebooks, letters, sale documents, old maps, etc)

No

Yes

If yes – please provide details

.....
.....

.....
.....
.....

22. Please give any further information which you consider would be helpful in reaching a decision as to whether the application route should be recorded as a public right of way?
[Continue on a separate sheet if necessary]
[If you wish to provide additional sketch map or drawings, please do so and attach to this statement]

The Grove is an important local facility for traffic-free walking

.....
.....
.....

23. During the investigation an officer from the Newcastle City Council may want to talk to or informally interview some or all of the users in order to gather additional information. Would you be willing to provide further information about your knowledge of the application route?

Yes
 No

24. Would you be willing to attend a hearing, or public inquiry to give evidence if necessary?

Yes
 No

Please make sure you have completed your contact details on pages i, and read the Data Protection information and signed the Statement of Truth on page ii.

Please remember to enclose a map showing the precise line of the route used.

This completed form plus any supporting evidence should either be returned to the person making the application, or if requested (if an application has already been submitted) direct to:

**Public Rights of Way
Place Directorate – Transport
Newcastle City Council
10th Floor, Civic Centre
Barras Bridge
Newcastle upon Tyne
NE1 1QH
Email: pro@newcastle.gov.uk**

Thank you for taking the time to complete this form.

Public Right of Way User Evidence Form

About the application route

'The Grove' Jeonon

Your ref: DMN06

1. Is the application route:

A footpath (public rights on foot only)

A bridleway (public rights on foot and on horseback or bicycle)

A restricted byway (public rights on foot, on horseback or any non-motorised vehicle)

A byway open to all traffic (public rights for all classes of use, including motor vehicles)

2. Describe the application route (include start and finish points and provide OS grid references if you can)

The route runs from to southern end of Queens Terrace
alongside 10 Queens Terrace in eastwards direction
past The House, Grosvenor House and to back-gardens of
Grosvenor Avenue until it reaches to southern end
of Reid Park Road.

The road runs between to back-gardens of to houses
in Grosvenor Avenue and Reid Park Road

Map of the application route

Please attach an extract from a map of your choice (1:2500 scale if possible) and identify the exact route you are providing evidence about (draw the route on the map so it is obvious). Please annotate the map with anything you provide details about in this form, for example, the location of a gate or sign. Please put your initials on your map and date it. **Please do not add your full signature.**

3. Why do you regard this way as public?

The way is:

- ① Is shown on 'old' OS maps and 're-cut' A-Z Maps.
- ② Is described as a 'public right of way' in a sale of Conveyance dated 24 July 1931 for 38 Grosvenor Avenue and no doubt in other sale of conveyances as well.
- ③ Has street lighting maintained by to Council.
- ④ Is part of to pilgrimage route and access to St Mary's Well.
- ⑤ Has clearly been used for many years, probably decades, by locals for walking, dog walking, occasional cycling etc.

Your use of the application route

4. In which years did you use the application route? *See S below*

From To

5. Were there any extended periods during which you did not use the route at all? If so, please state when and why?

I have used the route increasingly since my retirement from full time work in 2003. I cannot recall when I personally first started walking along the route. Regular use would have been after 2011.

6. How did you use the application route and how often? [Please tick any that apply]

	Daily	<input checked="" type="checkbox"/> Weekly	Monthly	Every few months	Once a year	Other (please describe)
On foot ✓		<i>2 or 3 times weekly in recent years.</i>				
On horseback						
By pedal cycle						
By motor vehicle						
By horse-drawn vehicle						

7. Where were you going, and for what purpose?

I have used the route for my daily exercise on the way to (from) Jesmond Dene and its environs.

8. Has the application route always followed the same course?

Yes

No

If no – how and when was the route altered?

.....

9. Approximately how wide is the application route?

[Please give your estimate of the width across which you used the route including the width used when passing others or walking with others. Take care to consider the overall width of the route. If this varies, please describe how. Or please state 'don't know']

The width varies - see my letter to the Council of 22 August 2012. I believe the Council (Simon Carey) inspected The Grove in August 2012 shortly after receiving my letter.

10. What type of surface does the application route have? (for example grass, gravel, earth)

[Are there any changes along its length]

It varies - mud/gravel etc. Inspection will show.

11. Have there ever been any of the following on the application route?

Stiles [state locations and show on your map]

NONE TO MY KNOWLEDGE.

How long were they in place?

Gates [state locations, indicate whether locked - and when - and show on your map]

NONE TO MY KNOWLEDGE.

Other barriers [state what they were and location, how long they were in place and show on your map]

NONE TO MY KNOWLEDGE.

12. Did any of the above prevent you from using the application route?

Not applicable - (there have been no barriers as far as I am aware.

Yes

If yes, please give details

13. Have you ever seen any signs or notices suggesting whether or not the application route is a public right of way? (for example "Private", "Keep Out", "No Right of Way" "Trespassers will be Prosecuted")

No
 Yes

The only signs put-up, I think in the last few years, relate to land/gardens etc to the side of the route and asking people not to park on the road (at Queens road near Grosvenor House at adjoining property).

If yes – state when and give details, including when they were present and mark their location on your map

Inspection will show where the above signs are.

14. Have you seen other people using the application route whilst you have been using it?

No
 Yes

If yes, please provide any additional information about this

I have regularly seen other walkers, dog walkers.
I have also seen, but less often, runners and the occasional cyclist.

Land Ownership

15. Were you working for any owner or occupier of land crossed by the application route at the time when you used it, or were you then a tenant / licensee of any such owner?

No
 Yes

16. Did the owner or occupier ever give you permission (or did you seek permission) to use the application route?

No
 Yes

17. Has anyone ever told you the application route was not public (including by an owner, tenant of the land or by anyone in their employment)?

No
 Yes

18. Have you ever been stopped or turned back when using the application route?

No

Yes

If yes, by whom and when?

.....
.....
.....

19. Has anyone else ever told you that they were prevented from using the application route?

No

Yes

If yes, please give details including when this happened

.....
.....
.....

20. Have you ever had a private right to use the application route? (for example, an easement, private right of access, licence, etc)

No

Yes

If yes, please give full details, including who gave the permission, why and when

.....
.....
.....

Other Information

21. Do you have, or do you have knowledge of, any documentary evidence which is relevant to the application route or which indicates public use? (for example photographs, guidebooks, letters, sale documents, old maps, etc)

No

Yes

If yes – please provide details

① Please see my letter of 14 September 2012 and the enclosed sale of conveyance for 38 Grosvenor Avenue dated 24th July 1931.

② An article taken from the internet on Tadmor 1850-1950

RTO

refers to "ST Mary's Well nearby on the footpath behind Grosvenor Road"

3. Walk 3' from Jesmond Pool, Gleatham Road includes 'Jesmond Cottage' and 'ST Mary's Well' shown on a Jesmond 1936 Map, but I don't know when the walk was publicised.

22. Please give any further information which you consider would be helpful in reaching a decision as to whether the application route should be recorded as a public right of way?
[Continue on a separate sheet if necessary]
[If you wish to provide additional sketch map or drawings, please do so and attach to this statement]

1. Please see the correspondence I had with Simon Caney from 22 August 2012 onwards.

2. Please see all the correspondence made concerning an application made for change of use from open space to garden at the northern end of the back garden of 34 Grosvenor Avenue received by the Council on 19 June 2020. Application 2020/0834/01/DIST.
Ref

23. During the investigation an officer from the Newcastle City Council may want to talk to or informally interview some or all of the users in order to gather additional information. Would you be willing to provide further information about your knowledge of the application route?

Yes - and to interpret my hand-writing if necessary!

No

24. Would you be willing to attend a hearing, or public inquiry to give evidence if necessary?

Yes I would be happy to attend a hearing, if we are still in the area, but would prefer not to give public oral evidence

No

Please make sure you have completed your contact details on pages i, and read the Data Protection information and signed the Statement of Truth on page ii.

Please remember to enclose a map showing the precise line of the route used.

This completed form plus any supporting evidence should either be returned to the person making the application, or if requested (if an application has already been submitted) direct to:

Public Rights of Way
Place Directorate - Transport
Newcastle City Council
10th Floor, Civic Centre
Barras Bridge
Newcastle upon Tyne
NE1 1QH
Email: pro@newcastle.gov.uk

Thank you for taking the time to complete this form.

Newcastle
City Council
Newcastle City Council
10th Floor, Civic Centre
Barras Bridge
Newcastle upon Tyne
NE1 1QH

While route shown xxx, including the publicly mentioned "end" of Reid Park Road.



Existing public highway (indicative only)

Plan to accompany User Evidence Form

Please draw clearly on the plan the route you have used, preferably in bold black

Scale: 1:1,500 at A4

Scale bar: 0 10 20 40 Meters

Please initial and date: [Redacted]

Initials: [Redacted]

Date: 16/08/23

For official use only

Ref: 24.

Public Right of Way User Evidence Form

About the application route

1. Is the application route:

A footpath (public rights on foot only)

A bridleway (public rights on foot and on horseback or bicycle)

A restricted byway (public rights on foot, on horseback or any non-motorised vehicle)

A byway open to all traffic (public rights for all classes of use, including motor vehicles)

2. Describe the application route (include start and finish points and provide OS grid references if you can)

See your map.

.....

.....

.....

.....

.....

.....

.....

.....

Map of the application route

Please attach an extract from a map of your choice (1:2500 scale if possible) and identify the exact route you are providing evidence about (draw the route on the map so it is obvious). Please annotate the map with anything you provide details about in this form, for example, the location of a gate or sign. Please put your initials on your map and date it. **Please do not add your full signature.**

3. Why do you regard this way as public?

.....

.....

.....

.....

Your use of the application route

4. In which years did you use the application route?

From 1967 To PRESENT

5. Were there any extended periods during which you did not use the route at all? If so, please state when and why?

NO

6. How did you use the application route and how often? [Please tick any that apply]

	Daily	Weekly	Monthly	Every few months	Once a year	Other (please describe)
On foot		✓				
On horseback						
By pedal cycle						
By motor vehicle						
By horse-drawn vehicle						

7. Where were you going, and for what purpose?

General walking, visiting St Marys Well and Chapel, walking my children to Jesmond Dene

8. Has the application route always followed the same course?

Yes

No

If no – how and when was the route altered?

.....

9. Approximately how wide is the application route?

[Please give your estimate of the width across which you used the route including the width used when passing others or walking with others. Take care to consider the overall width of the route. If this varies, please describe how. Or please state 'don't know']

It varies - no longer straight. Narrow in places where encroached by house holders.

10. What type of surface does the application route have? (for example grass, gravel, earth)

[Are there any changes along its length]

Remnants of what appears to be cutables near Reid Pk Road end.
Dirt and small stones makes up the rest.

11. Have there ever been any of the following on the application route?

Stiles [state locations and show on your map]

NO

How long were they in place?

Gates [state locations, indicate whether locked – and when – and show on your map]

NO

Other barriers [state what they were and location, how long they were in place and show on your map]

NO

12. Did any of the above prevent you from using the application route?

No

Yes

If yes, please give details

13. Have you ever seen any signs or notices suggesting whether or not the application route is a public right of way? (for example "Private", "Keep Out", "No Right of Way" "Trespassers will be Prosecuted")

No

Yes

If yes -- state when and give details, including when they were present and mark their location on your map

.....
.....
.....

14. Have you seen other people using the application route whilst you have been using it?

No

Yes

If yes, please provide any additional information about this

I've seen many people using this route

.....

Land Ownership

15. Were you working for any owner or occupier of land crossed by the application route at the time when you used it, or were you then a tenant / licensee of any such owner?

No

Yes

16. Did the owner or occupier ever give you permission (or did you seek permission) to use the application route?

No

Yes

17. Has anyone ever told you the application route was not public (including by an owner, tenant of the land or by anyone in their employment)?

No

Yes

18. Have you ever been stopped or turned back when using the application route?

No

Yes

If yes, by whom and when?

.....
.....
.....

19. Has anyone else ever told you that they were prevented from using the application route?

No

Yes

If yes, please give details including when this happened

.....
.....
.....

20. Have you ever had a private right to use the application route? (for example, an easement, private right of access, licence, etc)

No

Yes

If yes, please give full details, including who gave the permission, why and when

.....
.....
.....

Other Information

21. Do you have, or do you have knowledge of, any documentary evidence which is relevant to the application route or which indicates public use? (for example photographs, guidebooks, letters, sale documents, old maps, etc)

No

Yes

If yes – please provide details

unfortunately my printer is out of ink I'm enclosing a faded print of AN ACCOUNT OF JESMOND By FREDERICK WALTER DENDY published 1904. (Page 8) sorry its poor quality.

.....
.....
.....
22. Please give any further information which you consider would be helpful in reaching a decision as to whether the application route should be recorded as a public right of way?

[Continue on a separate sheet if necessary]

[If you wish to provide additional sketch map or drawings, please do so and attach to this statement]

See attached map & notes.

.....
.....
.....
.....
.....

23. During the investigation an officer from the Newcastle City Council may want to talk to or informally interview some or all of the users in order to gather additional information. Would you be willing to provide further information about your knowledge of the application route?

Yes

No

24. Would you be willing to attend a hearing, or public inquiry to give evidence if necessary?

Yes

No

Please make sure you have completed your contact details on pages i, and read the Data Protection information and signed the Statement of Truth on page ii.

Please remember to enclose a map showing the precise line of the route used.

This completed form plus any supporting evidence should either be returned to the person making the application, or if requested (if an application has already been submitted) direct to:

**Public Rights of Way
Place Directorate – Transport
Newcastle City Council
10th Floor, Civic Centre
Barras Bridge
Newcastle upon Tyne
NE1 1QH
Email: prow@newcastle.gov.uk**

Thank you for taking the time to complete this form.



Existing public highway (indicative only)

Plan to accompany User Evidence Form
Please draw clearly on the plan the route you have used, preferably in bold black

Scale: 1:1,500 at A4
Please initial and date.

Scale bar: 0 10 20 40 Meters

For official use only

Initials: _____
Date: _____

Ref: 25.

AN ACCOUNT OF JESMOND

site of the present Presbyterian Church, was continued along the line of St. George's Terrace and through the grounds of Jesmond Towers to the Jesmond Dene Road. The part of this footpath which extends from Osborne Road to Jesmond Dene Road still exists. There were two branches from this footpath. One led westward to the North Road, on the line of the present Forsyth Road, and the other eastward to Jesmond Village, approximately on the line of a cown Road and through the garden of Eldon House and Mr. Alderson's tennis ground. Eastward of Osborne Road it was diverted, by order of the City Council, to the line of the line which now leads from that road past the back of Jesmond Cottage to Jesmond village. A fifth footpath, which has recently been

PTO



AN ACCOUNT OF JESMOND.

By

FREDERICK WALTER DENNY

'Summer up remembrance of things past'
Shakespeare's Sonnets, Sonnet 30.

Newcastle upon Tyne.

MCMIV



15:12

An account of Jesmond
Page 8.

25.

By.

Frederick Walter Dendy.
Newcastle upon Tyne.
Published 1904.

.... site of the present Presbyterian church was continued along the line of St. George's Tower & through the grounds of Jesmond Towers to Jesmond Lane Road. The part of this foot path which extends from Osborne Rd. to Jesmond Lane Road still exists. There were two branches from this foot path. One led westward to the North Road, and the other eastward to Jesmond Village approx. on the line of Acorn Rd. & through the garden of Eldon House & Mr Alderson's tennis ground. Eastward of Osborne Rd. it was diverted, by order of the city Council, to the line of the lane which now leads from that Road past the back of Jesmond Cottage. to Jesmond Village.

Public Right of Way User Evidence Form

About the application route

1. Is the application route:

A footpath (public rights on foot only) ✓

A bridleway (public rights on foot and on horseback or bicycle)

A restricted byway (public rights on foot, on horseback or any non-motorised vehicle)

A byway open to all traffic (public rights for all classes of use, including motor vehicles)

2. Describe the application route (include start and finish points and provide OS grid references if you can)

From 'The Grove', along the rear of Grosvenor Ave, past 'St Mary's Well' to the end of the high stone wall at the junction of Queens Terrace cul-de-sac. It runs along the rear of Grosvenor House (used to be Ackhurst School). It is a cinder / stone track, clearly marked out and has a number of street lights along the route.

Map of the application route

Please attach an extract from a map of your choice (1:2500 scale if possible) and identify the exact route you are providing evidence about (draw the route on the map so it is obvious). Please annotate the map with anything you provide details about in this form, for example, the location of a gate or sign. Please put your initials on your map and date it. **Please do not add your full signature.**

3. Why do you regard this way as public?

It is used by walkers / dog walkers every day and has been this way for decades. There are no barriers to access and it forms access to St. Mary's Well, an old Pilgrims route. The Well has a civic sign at the entrance and is visited by the public.

Your use of the application route

4. In which years did you use the application route?

From 1987 To Present day

5. Were there any extended periods during which you did not use the route at all? If so, please state when and why?

No

6. How did you use the application route and how often? [Please tick any that apply]

	Daily	Weekly	Monthly	Every few months	Once a year	Other (please describe)
On foot	✓					
On horseback						
By pedal cycle						
By motor vehicle						
By horse-drawn vehicle						

7. Where were you going, and for what purpose?

Recreation and dog walking

8. Has the application route always followed the same course?

~~Yes~~
No

If no – how and when was the route altered?

The route was altered around ten years ago at the rear of 'Cravenor House'. A short alteration so that it runs parallel to Cravenor House, instead of a slight kink for around 20 metres (marked by street light).

9. Approximately how wide is the application route?

[Please give your estimate of the width across which you used the route including the width used when passing others or walking with others. Take care to consider the overall width of the route. If this varies, please describe how. Or please state 'don't know']

Around 1 1/2 metres, wider in places depending on undergrowth and time of year.

10. What type of surface does the application route have? (for example grass, gravel, earth)

[Are there any changes along its length]

gravel mainly.

11. Have there ever been any of the following on the application route?

Stiles [state locations and show on your map]

No

How long were they in place?

Gates [state locations, indicate whether locked – and when – and show on your map]

No

Other barriers [state what they were and location, how long they were in place and show on your map]

No

12. Did any of the above prevent you from using the application route?

No

Yes

If yes, please give details

13. Have you ever seen any signs or notices suggesting whether or not the application route is a public right of way? (for example "Private", "Keep Out", "No Right of Way" "Trespassers will be Prosecuted")

No

Yes

If yes -- state when and give details, including when they were present and mark their location on your map

There are one or two signs 'Private land' attached to houses of garden fences. These were added in the last few years.

14. Have you seen other people using the application route whilst you have been using it?

No

Yes

If yes, please provide any additional information about this

The route is used by a significant number of people every day, it is rare not to pass people on the route.

Land Ownership

15. Were you working for any owner or occupier of land crossed by the application route at the time when you used it, or were you then a tenant / licensee of any such owner?

No

Yes

16. Did the owner or occupier ever give you permission (or did you seek permission) to use the application route?

No

Yes

17. Has anyone ever told you the application route was not public (including by an owner, tenant of the land or by anyone in their employment)?

No

Yes

18. Have you ever been stopped or turned back when using the application route?

No

Yes

If yes, by whom and when?

.....
.....
.....

19. Has anyone else ever told you that they were prevented from using the application route?

No

Yes

If yes, please give details including when this happened

.....
.....
.....

20. Have you ever had a private right to use the application route? (for example, an easement, private right of access, licence, etc)

No

Yes

If yes, please give full details, including who gave the permission, why and when

.....
.....
.....

Other Information

21. Do you have, or do you have knowledge of, any documentary evidence which is relevant to the application route or which indicates public use? (for example photographs, guidebooks, letters, sale documents, old maps, etc)

No

Yes

If yes – please provide details

I have seen + read books on 'Old Jesmond' to indicate a route.

.....
.....
.....

22. Please give any further information which you consider would be helpful in reaching a decision as to whether the application route should be recorded as a public right of way?
[Continue on a separate sheet if necessary]
[If you wish to provide additional sketch map or drawings, please do so and attach to this statement]

.....
.....
.....
.....
.....

23. During the investigation an officer from the Newcastle City Council may want to talk to or informally interview some or all of the users in order to gather additional information. Would you be willing to provide further information about your knowledge of the application route?

Yes

No

24. Would you be willing to attend a hearing, or public inquiry to give evidence if necessary?

Yes

No

Please make sure you have completed your contact details on pages i, and read the Data Protection information and signed the Statement of Truth on page ii.

Please remember to enclose a map showing the precise line of the route used.

This completed form plus any supporting evidence should either be returned to the person making the application, or if requested (if an application has already been submitted) direct to:

**Public Rights of Way
Place Directorate – Transport
Newcastle City Council
10th Floor, Civic Centre
Barras Bridge
Newcastle upon Tyne
NE1 1QH
Email: prow@newcastle.gov.uk**

Thank you for taking the time to complete this form.

Newcastle
City Council
Newcastle City Council
10th Floor, Civic Centre
Barras Bridge
Newcastle upon Tyne
NE1 1QH

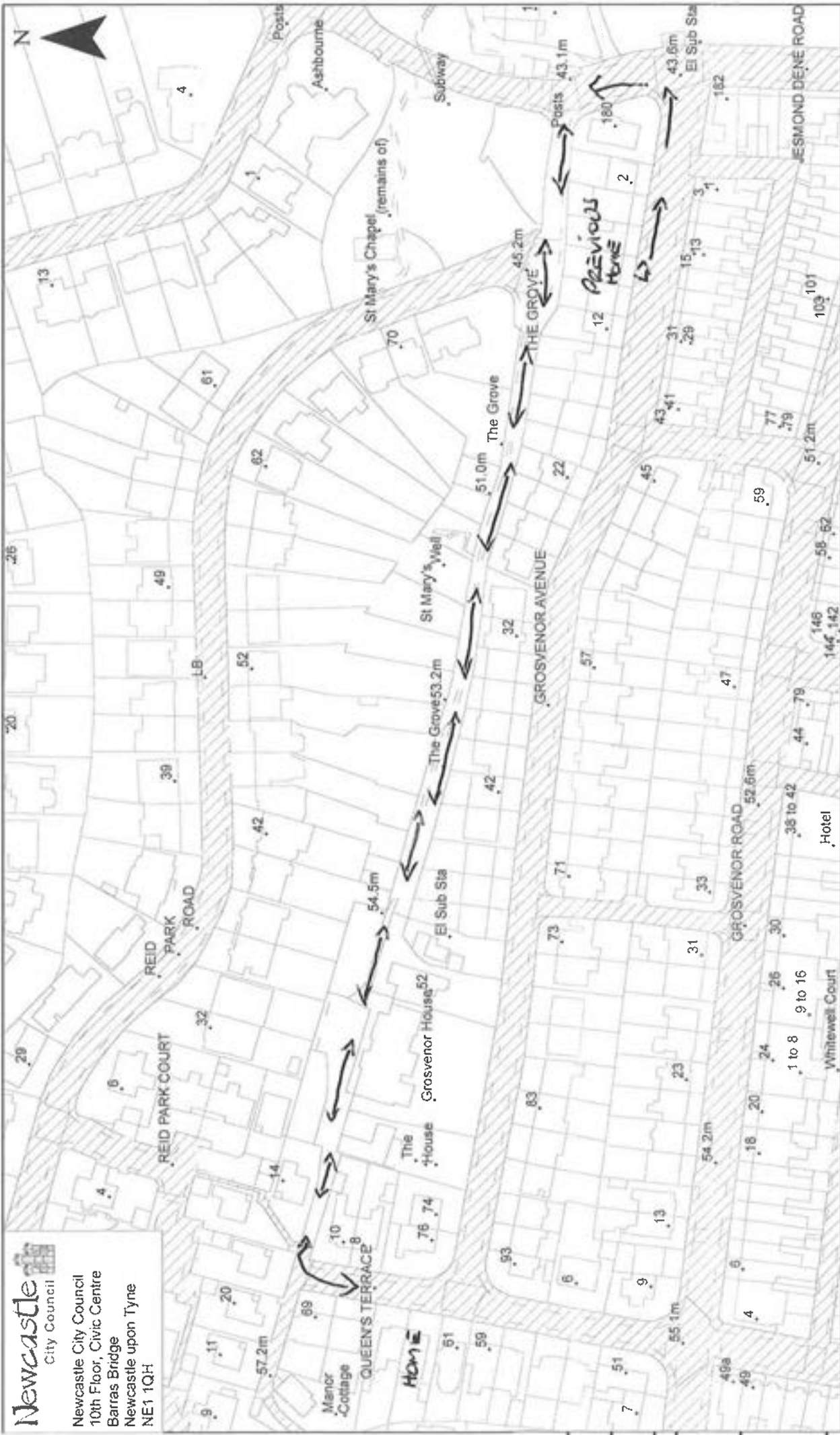

For official use only
Ref: 26.

Scale: 1:1,500 at A4
Scale bar: 0 10 20 40 Meters
Please initial and date:
Initials: [REDACTED]
Date: 27/7/23

Plan to accompany User Evidence Form
Existing public highway (indicative only)
Please draw clearly on the plan the route you have used, preferably in bold black

Public Right of Way User Evidence Form

About the application route

1. Is the application route:

A footpath (public rights on foot only)

A bridleway (public rights on foot and on horseback or bicycle)

A restricted byway (public rights on foot, on horseback or any non-motorised vehicle)

A byway open to all traffic (public rights for all classes of use, including motor vehicles)

2. Describe the application route (include start and finish points and provide OS grid references if you can)

From 'The Grove' along the rear of Grosvenor Ave, past ST. MARYS Well' to the end of the high stone wall at the junction of Queens Terrace cul-de sac. It runs along the rear of Grosvenor House (used to be Acturst School). It is a cinder/stone track, clearly marked out and has street lights along the route.

Map of the application route

Please attach an extract from a map of your choice (1:2500 scale if possible) and identify the exact route you are providing evidence about (draw the route on the map so it is obvious). Please annotate the map with anything you provide details about in this form, for example, the location of a gate or sign. Please put your initials on your map and date it. **Please do not add your full signature.**

3. Why do you regard this way as public?

It is used by walkers/dog walkers every day and has been this way for decades. There are no barriers to access.

Your use of the application route

4. In which years did you use the application route?

From To

5. Were there any extended periods during which you did not use the route at all? If so, please state when and why?

.....

.....

.....

6. How did you use the application route and how often? [Please tick any that apply]

	Daily	Weekly	Monthly	Every few months	Once a year	Other (please describe)
On foot						
On horseback						
By pedal cycle						
By motor vehicle						
By horse-drawn vehicle						

7. Where were you going, and for what purpose?

.....

.....

.....

8. Has the application route always followed the same course?

Yes

No

If no – how and when was the route altered?

.....

.....

9. Approximately how wide is the application route?

[Please give your estimate of the width across which you used the route including the width used when passing others or walking with others. Take care to consider the overall width of the route. If this varies, please describe how. Or please state 'don't know']

Around 1 1/2 metres, wider in places depending on undergrowth and time of year.

10. What type of surface does the application route have? (for example grass, gravel, earth)

[Are there any changes along its length]

Gravel mainly.

11. Have there ever been any of the following on the application route?

Stiles [state locations and show on your map]

No

How long were they in place?

No

Gates [state locations, indicate whether locked – and when – and show on your map]

No

Other barriers [state what they were and location, how long they were in place and show on your map]

No

12. Did any of the above prevent you from using the application route?

No

Yes

If yes, please give details

13. Have you ever seen any signs or notices suggesting whether or not the application route is a public right of way? (for example "Private", "Keep Out", "No Right of Way" "Trespassers will be Prosecuted")

No

Yes

If yes – state when and give details, including when they were present and mark their location on your map

There are a number of signs 'Private land' attached to wooden fences to the gardens of Cravenor Avenue. Added in the last 10 years.

14. Have you seen other people using the application route whilst you have been using it?

No

Yes

If yes, please provide any additional information about this

Almost every time we walk the route it is used by other people, it is rare not to pass on the route.

Land Ownership

15. Were you working for any owner or occupier of land crossed by the application route at the time when you used it, or were you then a tenant / licensee of any such owner?

No

Yes

16. Did the owner or occupier ever give you permission (or did you seek permission) to use the application route?

No

Yes

17. Has anyone ever told you the application route was not public (including by an owner, tenant of the land or by anyone in their employment)?

No

Yes

18. Have you ever been stopped or turned back when using the application route?

No

Yes

If yes, by whom and when?

.....
.....
.....

19. Has anyone else ever told you that they were prevented from using the application route?

No

Yes

If yes, please give details including when this happened

.....
.....
.....

20. Have you ever had a private right to use the application route? (for example, an easement, private right of access, licence, etc)

No

Yes

If yes, please give full details, including who gave the permission, why and when

.....
.....
.....

Other Information

21. Do you have, or do you have knowledge of, any documentary evidence which is relevant to the application route or which indicates public use? (for example photographs, guidebooks, letters, sale documents, old maps, etc)

No

Yes

If yes – please provide details

.....
.....

.....
.....
.....

22. Please give any further information which you consider would be helpful in reaching a decision as to whether the application route should be recorded as a public right of way?
[Continue on a separate sheet if necessary]
[If you wish to provide additional sketch map or drawings, please do so and attach to this statement]

.....
.....
.....
.....
.....

23. During the investigation an officer from the Newcastle City Council may want to talk to or informally interview some or all of the users in order to gather additional information. Would you be willing to provide further information about your knowledge of the application route?

Yes

No

24. Would you be willing to attend a hearing, or public inquiry to give evidence if necessary?

Yes

No

Please make sure you have completed your contact details on pages i, and read the Data Protection information and signed the Statement of Truth on page ii.

Please remember to enclose a map showing the precise line of the route used.

This completed form plus any supporting evidence should either be returned to the person making the application, or if requested (if an application has already been submitted) direct to:

**Public Rights of Way
Place Directorate – Transport
Newcastle City Council
10th Floor, Civic Centre
Barras Bridge
Newcastle upon Tyne
NE1 1QH
Email: prow@newcastle.gov.uk**

Thank you for taking the time to complete this form.

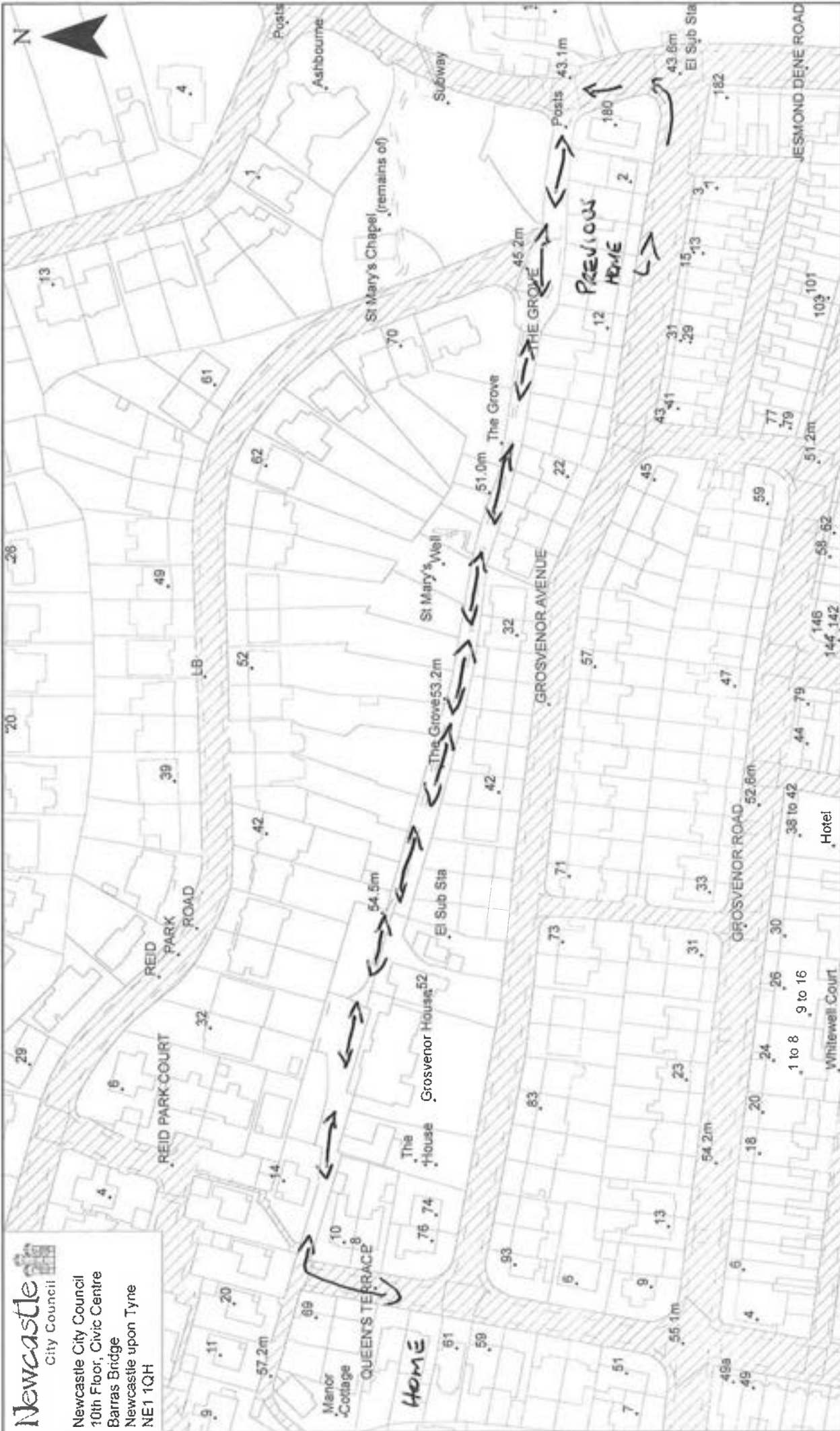

Existing public highway (indicative only)

Plan to accompany User Evidence Form
Please draw clearly on the plan the route you have used, preferably in bold black

Please initial and date:

Initials: [REDACTED]

Date: 27/7/23

Scale: 1:1,500 at A4

Scale bar: 0 10 20 40 Meters

For official use only

Ref:

27.